



## S-Series™

### 2.0 Rubber Hose STAUFF Clamps

**Date:** November 7, 2023  
**Bulletin Name:** FDM-TSIB-047  
**Model:** Oshkosh S-Series 2.0  
**Units Affected:** Serial No. 788727 - 827508

### Purpose:

This bulletin provides instructions for installing rubber hose STAUFF clamps in areas of the vehicle that have hard line STAUFF clamps installed on rubber hoses. Rubber hose STAUFF clamps have a smooth inner contact surface and filleted edges. Installing rubber hose STAUFF clamps will reduce potential hose chaffing in areas where hard line clamps were installed.

### Notice:

- Read and understood bulletin in its entirety before performing this procedure.
- All procedures outlined in the bulletin must be performed by skilled service personnel. Refer to the product service manual for descriptions of maintenance procedures.

### SAFETY NOTICE

Perform your company's Lockout/Tagout procedure. If your company does not have a Lockout/Tagout procedure, follow OSHA 1910.147 and 1910.146 Confined Space as appropriate.

### SAFETY NOTICE

Use appropriate Personal Protective Equipment (PPE) as required by your company.

### Tools and Equipment Required:

Customer to supply:

- Hand tools
- Torque wrench (foot pound)
- Loctite® 242

### Parts Required

Item	Part Number	Description	Qty.
<b>Power Chute Assembly</b>			
1	A000A519	SCR, FLG, HEX, 0.31-18 X 1.5", G8 MB	5
2	A000A520	SCR, FLG, HEX, 0.31-18 X 1.75", G8 MB	1
3	A000G257	CLAMP, TWIN, 0.50 - 0.50", PP	6
<b>Mixer Motor Assembly</b>			
5	A000A733	SCR, CAP, HEX, 0.31-18 X 3.25", G8 MB	1
6	A000A689	NUT, FLG, LKDT, 0.31-18, G8 MB	1
7	A000G276	CLAMP, TWIN, 1.50 - 1.50", PP	1

### Procedure:

#### Lockout/Tagout

1. Park vehicle on a flat level surface, block truck tires, and perform your company's Lockout/Tagout procedure. If your company does not have a Lockout/Tagout procedure, follow OSHA 1910.147 and 1910.146 Confined Space as appropriate.
2. The vehicle's BATTERY DISCONNECT switch is located on the left-hand side of the battery box. Use the battery disconnect switch when performing any maintenance so the vehicle cannot accidentally be started.

- a. Turn the battery disconnect switch (Figure A, Item 1) counterclockwise so the hole on the switch aligns with the hole in the bracket (Figure A, Item 2).
- b. Install the safety lockout device ring (Figure B, Item 1) through the holes on the battery disconnect switch and the bracket.
- c. Install a padlock (Figure B, Item 2) onto the safety lockout device ring, lock it, and put the key in your pocket. If more than one person is working on the vehicle, each person must install his or her own padlock.

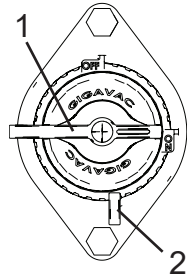

Figure A

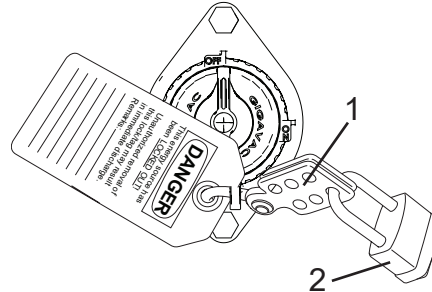

Figure B

### Power Chute Assembly STAUFF Clamp Replacement

#### **CAUTION**

Inspect all rubber hoses having hard line STAUFF clamp bodies replaced for signs of wear. Replace any hose showing signs of wear. Failure to comply could result in equipment damage.

3. Locate the 5 hard line STAUFF clamps on the power chute assembly first and second sections, and one on the lift cylinder. See Figure 1.

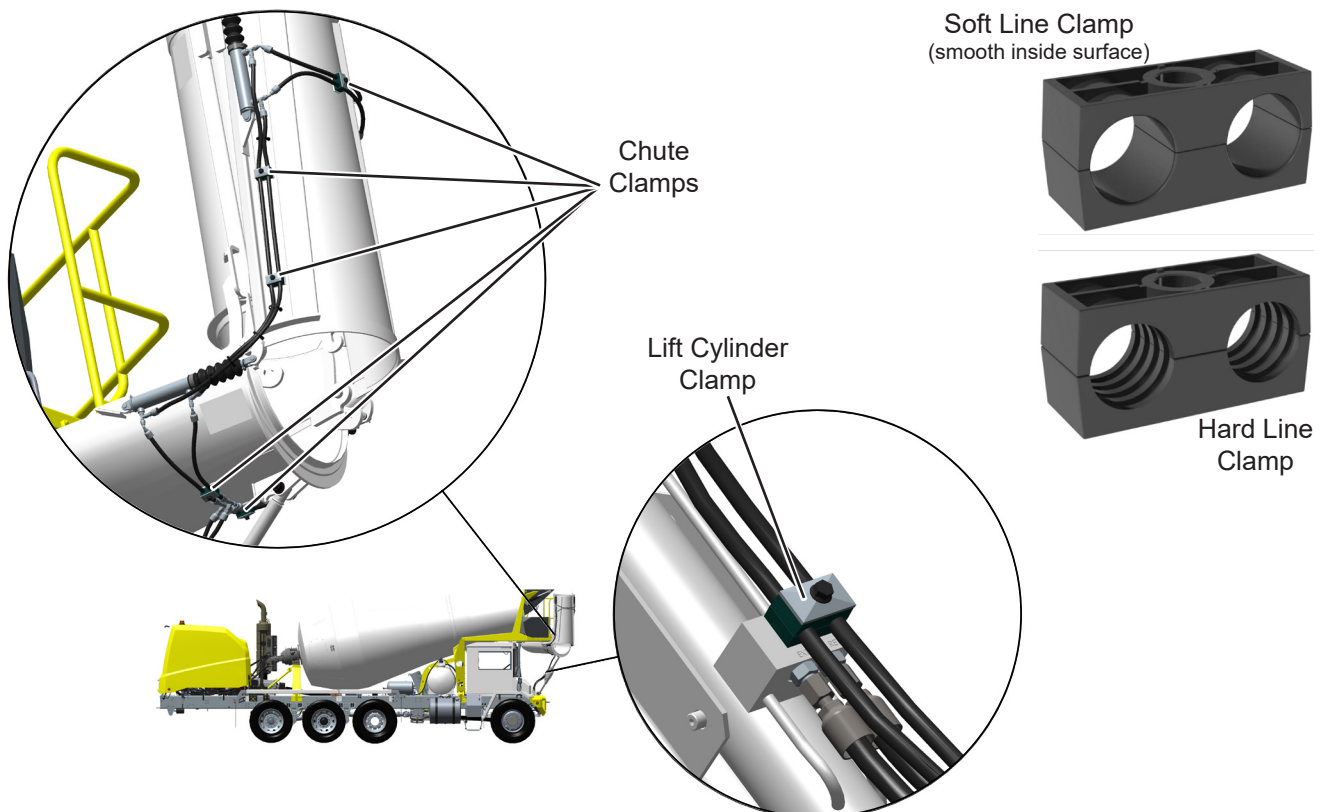
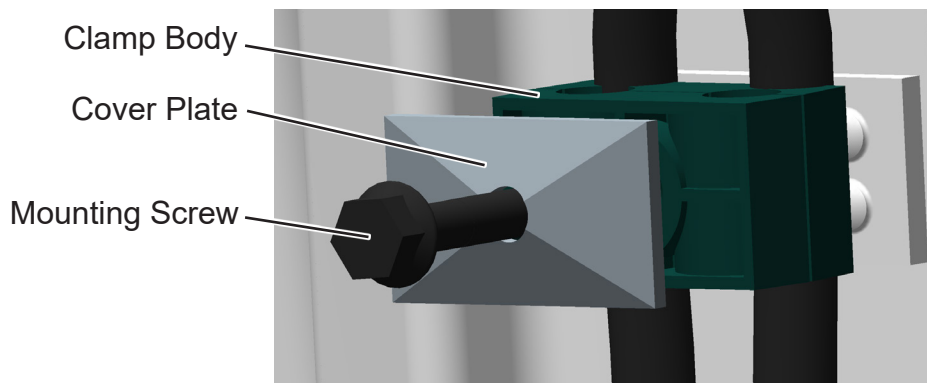

Figure 1 - Power Chute STAUFF Clamps

4. Loosen and remove mounting screw from one of the power chute section clamps. Screw will not be reused.
5. Remove cover plate from clamp body. Save cover plate for reinstallation.
6. Remove clamp body from rubber hoses. Clamp body will not be reused.
7. Inspect rubber hoses for wear and replace as required.
8. Install new clamp body (A000G257) on rubber hoses.
9. Reinstall cover plate on clamp body.
10. Apply Loctite® 242 to threads of new hex flange screw (A000A519) and install in cover plate. See Figure 2.
11. Perform Step 4-10 to remaining 4 power chute section clamps.
12. Loosen and remove mounting screw from lift cylinder clamp. Screw will not be reused.
13. Remove cover plate from clamp body. Save cover plate for reinstallation.
14. Remove clamp body from rubber hoses. Clamp body will not be reused.
15. Install new clamp body (A000G257) on rubber hoses.
16. Reinstall cover plate on clamp body.
17. Apply Loctite® 242 to threads of new hex flange screw (A000A520) and install in cover plate. See Figure 2.



*Figure 2 - STAUFF Clamp Assembly*

### **Mixer Motor STAUFF Clamp Replacement**

18. Locate mixer motor hydraulic lines on right side of cooling package base. See Figure 3.
19. Loosen and remove screw and nut securing clamp to bracket.
20. Remove cover plate from clamp. Save cover plate for reinstallation.
21. Remove clamp body from rubber hoses. Clamp body will not be reused.
22. Install new clamp body (A000G276) on rubber hoses.
23. Reinstall cover plate on clamp body.
24. Install new hex cap screw (A000A733) in clamp assembly and install new locknut (A000A689) on screw to secure clamp to bracket. See Figure 3. Final tighten mounting screw and nut to 18 ft. lbs.

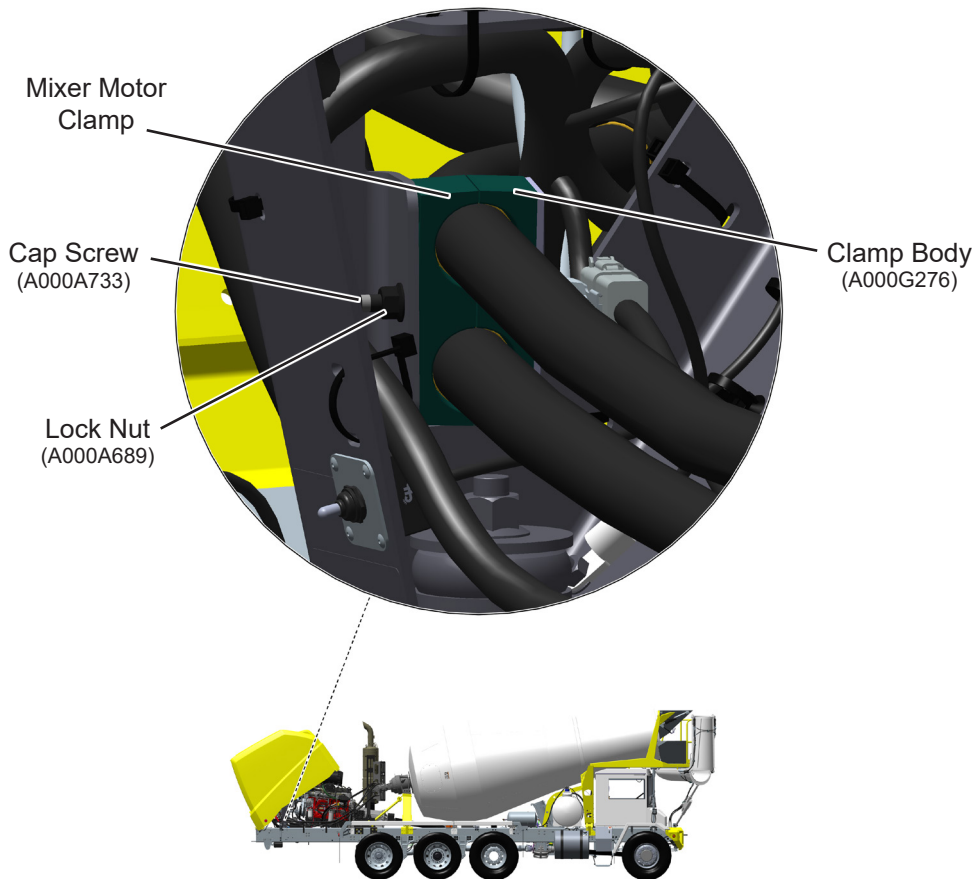

Figure 3 - Power Chute STAUFF Clamps

25. Remove lockout/tag and wheel chocks.

### **Continuous Improvement:**

The change included in this document is part of the McNeilus Continuous Improvement Process.

*McNeilus's quality policy is providing customer satisfaction through innovative products, dedicated service, and a constant focus on continuous improvement.*



(888) 686-7278

[www.streetsmartparts.com](http://www.streetsmartparts.com)