



Technical Service Bulletin

SUBJECT: CORRECTION OF LUBRICANT BRANDS FOR TRANSMISSION & DRIVELINE – SERVICE MANUAL REVISION			No: TSB-23-23-005
			DATE: December 2023
			MODEL: Outlander
CIRCULATE TO:	<input type="checkbox"/> GENERAL MANAGER	<input checked="" type="checkbox"/> PARTS MANAGER	<input checked="" type="checkbox"/> TECHNICIAN
<input checked="" type="checkbox"/> SERVICE ADVISOR	<input checked="" type="checkbox"/> SERVICE MANAGER	<input checked="" type="checkbox"/> WARRANTY PROCESSOR	<input type="checkbox"/> SALES MANAGER

PURPOSE

This TSB provides correction to the brand name of lubricants for the Transmission & Driveline in the applicable Service Manual sections:

- Transfer
- Electro-Hydraulic Coupling
- Differential Gear

AFFECTED VEHICLES

2022-2023 Outlander

AFFECTED SERVICE MANUAL

- 2022-2023 Outlander Service Manual

PROCEDURE

Please use the following chart as a guide to replace the indicated pages in the affected Service Manuals, Group 23, Transmission & Driveline, Driveline and Group 00 Maintenance, Periodic Maintenance.



Copyright 2023, Mitsubishi Motors North America, Inc.

The information contained in this bulletin is subject to change. For the latest version of this document, go to the Mitsubishi Dealer Link, MEDIC, or the Mitsubishi Service Information website (www.mitsubishitechinfo.com).

Applicable Manual	No.	Applicable Title	Contents
2022 OUTLANDER Service Manual	MSCD-030B-2022 (Volume 2)	TRANSMISSION & DRIVELINE <ul style="list-style-type: none"> └ DRIVELINE <ul style="list-style-type: none"> └ REAR FINAL DRIVE: R145 <ul style="list-style-type: none"> └ PREPARATION <ul style="list-style-type: none"> └ PREPARATION <ul style="list-style-type: none"> └ Lubricant or/and Sealant 	Attached sheet 2
		TRANSMISSION & DRIVELINE <ul style="list-style-type: none"> └ DRIVELINE <ul style="list-style-type: none"> └ REAR FINAL DRIVE: R145 <ul style="list-style-type: none"> └ UNIT REMOVAL AND INSTALLATION <ul style="list-style-type: none"> └ REAR FINAL DRIVE ASSEMBLY <ul style="list-style-type: none"> └ Adjustment 	Attached sheet 3
	MSCD-030B-2022 (Volume 5)	MAINTENANCE <ul style="list-style-type: none"> └ PERIODIC MAINTENANCE <ul style="list-style-type: none"> └ RECOMMENDED FLUIDS AND LUBRICANTS <ul style="list-style-type: none"> └ Fluids and Lubricants 	Attached sheet 4
2023 OUTLANDER Service Manual	MSCD-030B-2023	TRANSMISSION & DRIVELINE <ul style="list-style-type: none"> └ DRIVELINE <ul style="list-style-type: none"> └ REAR FINAL DRIVE: R145 <ul style="list-style-type: none"> └ PREPARATION <ul style="list-style-type: none"> └ PREPARATION <ul style="list-style-type: none"> └ Lubricant or/and Sealant 	Attached sheet 2
		TRANSMISSION & DRIVELINE <ul style="list-style-type: none"> └ DRIVELINE <ul style="list-style-type: none"> └ REAR FINAL DRIVE: R145 <ul style="list-style-type: none"> └ UNIT REMOVAL AND INSTALLATION <ul style="list-style-type: none"> └ REAR FINAL DRIVE ASSEMBLY <ul style="list-style-type: none"> └ Adjustment 	Attached sheet 3
		MAINTENANCE <ul style="list-style-type: none"> └ PERIODIC MAINTENANCE <ul style="list-style-type: none"> └ RECOMMENDED FLUIDS AND LUBRICANTS <ul style="list-style-type: none"> └ Fluids and Lubricants 	Attached sheet 5

DRIVELINE

153

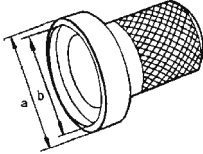
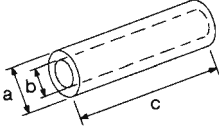
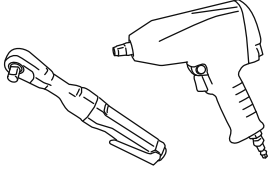
Tool name	Description
Drift a: 63 mm (2.48 in) dia. b: 49 mm (1.93 in) dia.  CF100AC5AA00USA	Installing side oil seal
Drift a: 60 – 73 mm (2.36 – 2.87 in) dia. b: 24 – 53 mm (0.94 – 2.09 in) dia. c: 68 mm (2.68 in) or more  CF100AC6AA00USA	Installing drive pinion oil seal
Power tool  CF100A1DAA00USA	Loosening bolts and nuts

Lubricant or/and Sealant

Item	Use
Electro-hydraulic coupling oil (Mitsubishi Genuine part) <Incorrect>	Filling when the parts of electro-hydraulic coupling assembly and/or rear final drive assembly is disassembled
Red lead or equivalent	Checking tooth contact

BorgWarner LSC Transmission Fluid 12-301
<Correct>

INSTALLATION

Note the following, install in the reverse order of removal.

- For non-reusable parts, refer to [REAR FINAL DRIVE ASSEMBLY](#).
- For each tightening torque, refer to [REAR FINAL DRIVE ASSEMBLY](#).
- When oil leaks while removing/installing final drive assembly, check oil level after the installation. Refer to [REAR DIFFERENTIAL GEAR OIL](#).
- Perform adjustment after installation. Refer to [REAR FINAL DRIVE ASSEMBLY](#).

Adjustment

ADJUSTMENT BEFORE REMOVAL

AWD Control Unit Part Number Saving

When replacing AWD control unit (integrated with actuator assembly of electro-hydraulic coupling assembly) and electro-hydraulic coupling assembly, perform AWD control unit part number saving. Refer to [ADDITIONAL SERVICE WHEN REPLACING AWD CONTROL UNIT \(IN ELECTRO-HYDRAULIC COUPLING\)](#).

ADJUSTMENT AFTER INSTALLATION

AWD Control Unit Programming

When replacing AWD control unit (integrated with actuator assembly of electro-hydraulic coupling assembly) and electro-hydraulic coupling assembly, perform programming to AWD control unit. Refer to [ADDITIONAL SERVICE WHEN REPLACING AWD CONTROL UNIT \(IN ELECTRO-HYDRAULIC COUPLING\)](#).

Electro-Hydraulic Coupling Oil Filling, Air Bleeding and Initialize Oil Deterioration Level

When the electro-hydraulic coupling oil is drained, such as when replacing or removing/installing electro-hydraulic coupling component parts, the air bleeding and initialize oil deterioration level of electro-hydraulic coupling oil is required after fill with new electro-hydraulic coupling oil.

Refilling for electro-hydraulic coupling oil

Fill with electro-hydraulic coupling oil following the instructions below.

1. Remove filler plug ① and gasket ② from coupling oil tank cover ③.

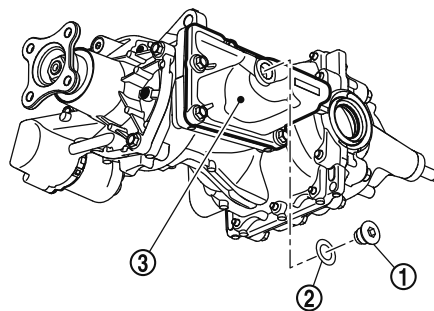

CF100ACTAA00USA

2. Fill with new electro-hydraulic coupling oil to specified amount.

Specified amount : Approx. 0.6 ℓ (1-1/4 US pt, 1 Imp pt)

Use BorgWarner LSC Transmission Fluid 12-301 for the electro-hydraulic coupling oil. <Correct>

CAUTION:

- ~~Use only genuine Mitsubishi Motors parts for electro-hydraulic coupling oil.~~ <Incorrect>
- When using oil, allow the additives to diffuse well before use.
- Oil that has been stored for 12 months can not be used.



NOTE:

Oil level should be level with bottom of filler plug mounting hole.

RECOMMENDED FLUIDS AND LUBRICANTS

Fluids and Lubricants

The following are approximate capacities. The actual refill capacities may be slightly different. When refilling, follow the procedures described elsewhere in this manual

Fluid type		Capacity (approximate)			Recommended Fluids/Lubricants
		Metric Measure	US Measure	Imperial Measure	
Engine oil Drain and refill	With oil filter change	5.1 l	5-3/8 qt	4-4/8 qt	<ul style="list-style-type: none"> Genuine "Mitsubishi Motors Motor Oil 0W-20 SN" (or equivalent) is recommended. If the above motor oil (or engine oil) is not available, a synthetic 0W-20 GF-5 SN motor oil (or engine oil) may be used. Damage caused by the use of motor oil (or engine oil) other than as recommended is not covered under Mitsubishi Motors's New Vehicle Limited Warranty. For additional information, see "Engine Oil Recommendations".
	Without oil filter change	4.8 l	5-1/8 qt	4-2/8 qt	
Dry engine (engine overhaul)		6.4 l	6-6/8 qt	5-5/8 qt	
Engine coolant (with reservoir tank)		9.4 l	9-9/10 qt	8-3/10 qt	<ul style="list-style-type: none"> Pre-diluted MITSUBISHI MOTORS GENUINE SURPER LONG LIFE COOLANT PREMIUM or equivalent
Reservoir tank		0.83 l	7/8 qt	6/8 qt	
CVT fluid		7.4 l	7-7/8 qt	6-1/2 qt	<ul style="list-style-type: none"> MITSUBISHI MOTORS GENUINE CVTF-J4 Use only "Mitsubishi Motors Genuine CVTF-J4" transmission fluid to ensure optimum transmission performance.
Transfer oil		0.31 l	5/8 pt	1/2 pt	<ul style="list-style-type: none"> Nissan Genuine Differential Oil Hypoid Super-S GL-5 synthetic 75W-90 or equivalent
Differential gear oil		0.5 l	1 pt	7/8 pt	<ul style="list-style-type: none"> Nissan Genuine HYPOID FLUID-S1 GL-5 75W-80 or equivalent
Brake fluid		—	—	—	<ul style="list-style-type: none"> Brake Fluid DOT 3 or DOT 4 <Incorrect> Available in mainland U.S.A. through a Mitsubishi Motors dealer.
Multi-purpose grease		—	—	—	<ul style="list-style-type: none"> NLGI No. 2 (Lithium soap base)

Engine Oil Recommendation

Mitsubishi Motors recommends the use of an resource conserving oil in order to improve fuel economy.

Select only engine oils that meet the American Petroleum Institute (API) certification and International Lubricant Standardization and Approval Committee (ILSAC) certification and SAE viscosity standard. These oils have the API certification mark on the front of the container. Oils which do not have the specified quality label should not be used as they could cause engine damage.

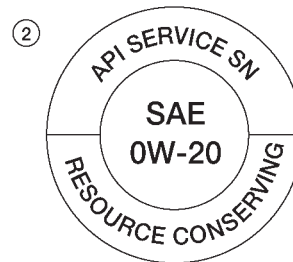

CF100CJZAA00USA

1. API certification mark	2. API service symbol
---------------------------	-----------------------

- Genuine NISSAN Differential Oil Hypoid Super-S GL-5 synthetic 75W-90 or equivalent
- Genuine NISSAN HYPOID FLUID-S1 GL-5 75W-80 or equivalent

<Correct>

RECOMMENDED FLUIDS AND LUBRICANTS

Fluids and Lubricants

The following are approximate capacities. The actual refill capacities may be slightly different. When refilling, follow the procedures described elsewhere in this manual

Fluid type		Capacity (approximate)			Recommended Fluids/Lubricants
		Metric Measure	US Measure	Imperial Measure	
Engine oil	With oil filter change	5.1 l	5-3/8 qt	4-1/2 qt	<ul style="list-style-type: none"> Genuine "MITSUBISHI MOTORS GENUINE MOTOR OIL SP 0W-20" (or equivalent, or higher) is recommended. If the above motor oil (or engine oil) is not available, a synthetic 0W-20 GF-5 SN (or higher) motor oil (or engine oil) may be used. Damage caused by the use of motor oil (or engine oil) other than as recommended is not covered under Mitsubishi Motor's New Vehicle Limited warranty. For additional information, see "Engine oil and oil filter recommendation".
Drain and refill	Without oil filter change	4.8 l	5-1/8 qt	4-1/4 qt	
Dry engine (engine overhaul)		6.4 l	6-3/4 qt	5-5/8 qt	
Engine coolant (with reservoir tank)		9.4 l	9-9/10 qt	8-3/10 qt	<ul style="list-style-type: none"> MITSUBISHI MOTORS GENUINE SUPER LONG LIFE COOLANT PREMIUM or equivalent
Reservoir tank		0.8 l	7/8 qt	3/4 qt	
CVT fluid		7.4 l	7-7/8 qt	6-1/2 qt	<ul style="list-style-type: none"> MITSUBISHI MOTORS GENUINE CVTF-J4 Use only "Mitsubishi Motors Genuine CVTF-J4" transmission fluid to ensure optimum transmission performance.
Transfer oil		0.31 l	5/8 pt	1/2 pt	<ul style="list-style-type: none"> Nissan Genuine Differential Oil Hypoid Super-S GL-5 synthetic 75W-90 or equivalent Nissan Genuine HYPOID FLUID-S1 GL-5 75W-80 or equivalent
Differential gear oil		0.5 l	1 pt	7/8 pt	
Brake fluid		—	—	—	<ul style="list-style-type: none"> Brake Fluid DOT 3 or DOT 4 <Incorrect> Available in mainland U.S.A. through a Mitsubishi Motors dealer.
Multi-purpose grease		—	—	—	<ul style="list-style-type: none"> NLGI No. 2 (Lithium soap base)

Engine Oil Recommendation

Mitsubishi Motors recommends the use of an resource conserving oil in order to improve fuel economy.

Select only engine oils that meet the American Petroleum Institute (API) certification and International Lubricant Standardization and Approval Committee (ILSAC) certification and SAE viscosity standard. These oils have the API certification mark on the front of the container. Oils which do not have the specified quality label should not be used as they could cause engine damage.

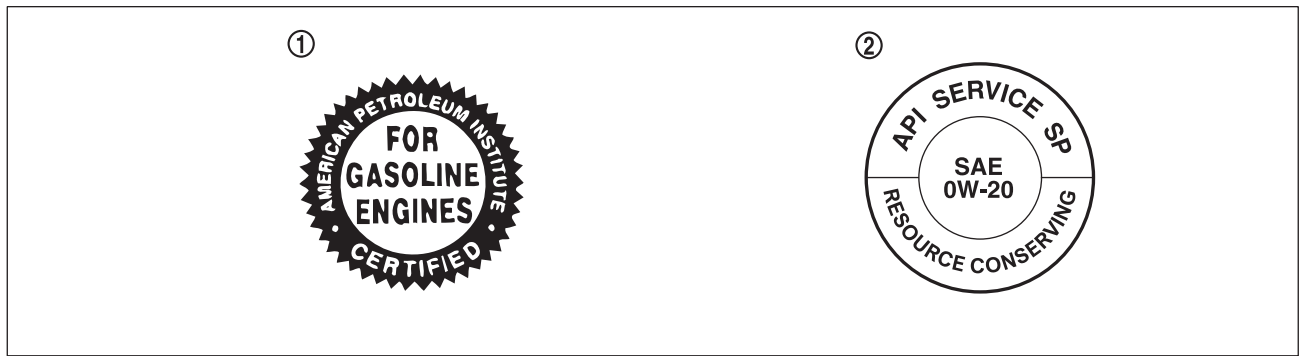

DF100CJZAC00USA

1.	ILSAC certification symbol	2.	API service symbol
----	----------------------------	----	--------------------

- Genuine NISSAN Differential Oil Hypoid Super-S GL-5 synthetic 75W-90 or equivalent
- Genuine NISSAN HYPOID FLUID-S1 GL-5 75W-80 or equivalent

<Correct>