



# TECHNICAL SERVICE BULLETIN

Classification: EM24-001	Reference: NTB24-014	Date: February 23, 2024
-----------------------------	-------------------------	----------------------------

## DRIVER (LH) SIDE ENGINE INSULATOR MOUNT REPLACEMENT

**APPLIED VEHICLES:** 2021-2024 Rogue (T33)

### SERVICE INFORMATION

Refer to the **SERVICE PROCEDURE** in this bulletin for instruction on how to replace the Driver (LH) Side Engine Insulator Mount for KR15 and PR25 engines.

**HINT:** The ESM will be updated with this procedure at a later date.

- KR15DDT Driver (LH) Side Engine Insulator Mount Replacement: Pages 2 – 4
- PR25DD Driver (LH) Side Engine Insulator Mount Replacement: Pages 5 – 7

Bulletins are intended for use by qualified technicians, not 'do-it-yourselfers'. Qualified technicians are properly trained individuals who have the equipment, tools, safety instruction, and know-how to do a job properly and safely. **NOTE:** If you believe that a described condition may apply to a particular vehicle, DO NOT assume that it does. See your Nissan dealer to determine if this applies to your vehicle.

## SERVICE PROCEDURE

### KR15DDT Removal

1. Remove the front grille cover.
  - Refer to the ESM: **BODY EXTERIOR, DOORS, ROOF & VEHICLE SECURITY > EXTERIOR > REMOVAL AND INSTALLATION > FRONT GRILLE > Removal and Installation**
2. Remove the air duct (inlet).
  - Refer to the ESM: **ENGINE > ENGINE MECHANICAL > KR15DDT > REMOVAL AND INSTALLATION > AIR CLEANER AND AIR DUCT > Removal and Installation**
3. Remove the battery.
  - Refer to the ESM: **ELECTRICAL & POWER CONTROL > POWER SUPPLY, GROUND & CIRCUIT ELEMENTS > REMOVAL AND INSTALLATION > BATTERY > Removal and Installation**
4. Remove the engine cover.
  - Refer to the ESM: **ENGINE > ENGINE MECHANICAL > KR15DDT > REMOVAL AND INSTALLATION > ENGINE COVER > Removal and Installation**
5. Remove the resonator hose from the resonator.
6. Remove the purge control valve hose 2 from the air duct.
  - Refer to the ESM: **ENGINE > ENGINE MECHANICAL > KR15DDT > REMOVAL AND INSTALLATION > PURGE PUMP > Removal and Installation**
7. Remove the air duct and resonator.
8. Disconnect the harness retainer from the mass air flow sensor, and then remove the harness retainer from the air cleaner cover.
9. Remove the bolt, and then remove the air cleaner assembly.
10. Disconnect the harness connectors from the ECM.

11. Press the pawl of engine room harness (1) and pull up engine room harness in the direction of the arrow.

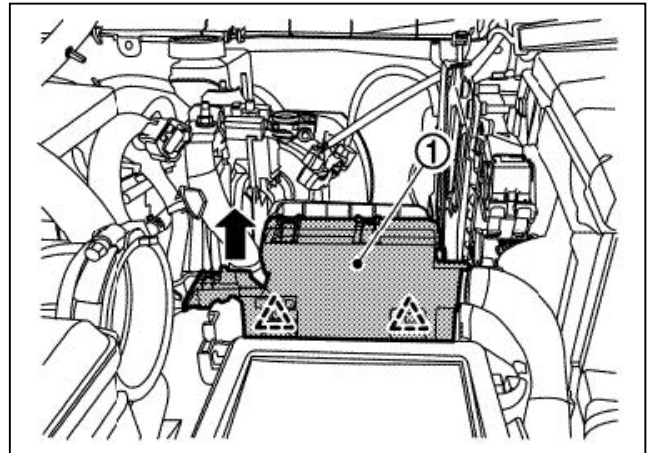

Figure 1

12. Remove the battery mounting bracket, battery tray 1 and battery tray 2.
  - Refer to the ESM: **ELECTRICAL & POWER CONTROL > POWER SUPPLY, GROUND & CIRCUIT ELEMENTS > REMOVAL AND INSTALLATION > BATTERY TRAY > Removal and Installation**
13. Remove the engine under cover.
  - Refer to the ESM: **BODY EXTERIOR, DOORS, ROOF & VEHICLE SECURITY > EXTERIOR > REMOVAL AND INSTALLATION > ENGINE UNDER COVER > Removal and Installation**
14. Remove the LH side wheel and tire assembly.
15. Remove the LH side splash guard.
16. Remove the LH side engine mounting insulator's body side lower bolts from underneath the vehicle.
17. Support the engine and transaxle assembly using a suitable jack.

**NOTICE**

To avoid damage to the vehicle, place the jack in an area to not damage the lower engine oil pan or transaxle oil pan.

## KR15DDT Installation

18. Install and tighten the LH side engine mounting insulator bolts in the sequence shown in Figure 2.

**HINT:** The arrow designates the front of the vehicle.

- Engine insulator bolt torque:  
62 N•m (6.3 kg-m, **46 ft-lb**)

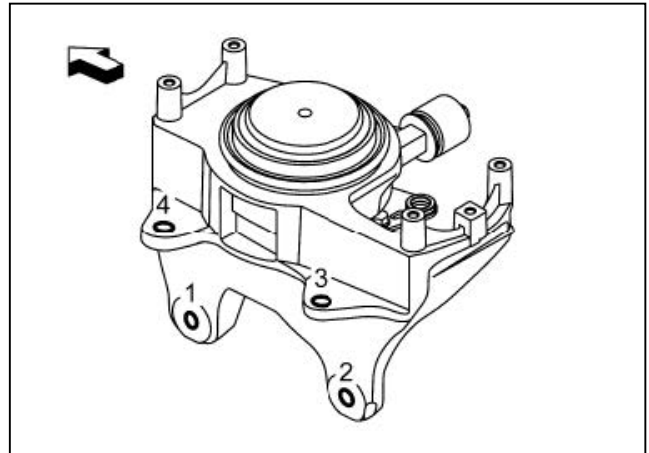

Figure 2

19. Tighten the bolts to the specified torque.

**HINT:** The arrow designates the front of the vehicle.

- Bolts (A) torque: 110 N•m  
(11 kg-m, **81 ft-lb**)
- Bolts (B) torque: 21 N•m  
(2.1 kg-m, **15 ft-lb**)

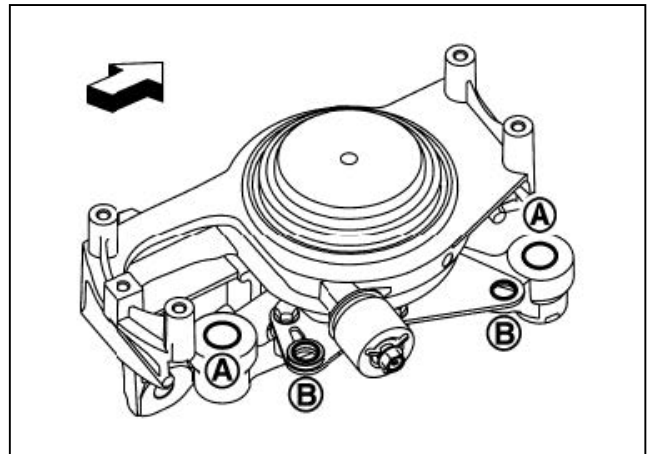

Figure 3

20. Reinstall all components in the reverse order of removal.

21. Perform **ADDITIONAL SERVICE WHEN REMOVING BATTERY NEGATIVE TERMINAL.**

- **ELECTRICAL & POWER CONTROL > POWER SUPPLY, GROUND & CIRCUIT ELEMENTS > BASIC INSPECTION > INSPECTION AND ADJUSTMENT > ADDITIONAL SERVICE WHEN REMOVING BATTERY NEGATIVE TERMINAL**

## PR25DD Removal

22. Remove the front grille cover.
  - Refer to the **ESM: BODY EXTERIOR, DOORS, ROOF & VEHICLE SECURITY > EXTERIOR > REMOVAL AND INSTALLATION > FRONT GRILLE > Removal and Installation**
23. Remove the air duct (inlet).
  - Refer to the **ESM: ENGINE > ENGINE MECHANICAL > PR25DD > REMOVAL AND INSTALLATION > AIR CLEANER AND AIR DUCT > Removal and Installation**
24. Remove the battery.
  - Refer to the **ESM: ELECTRICAL & POWER CONTROL > POWER SUPPLY, GROUND & CIRCUIT ELEMENTS > REMOVAL AND INSTALLATION > BATTERY > Removal and Installation**
25. Remove the air duct from the air cleaner cover.
  - Refer to the **ESM: ENGINE > ENGINE MECHANICAL > PR25DD > REMOVAL AND INSTALLATION > AIR CLEANER AND AIR DUCT > Removal and Installation**
26. Disconnect the harness retainer from the mass air flow sensor, and then remove the harness retainer from the air cleaner cover.
27. Remove the bolt, and then remove the air cleaner assembly.
28. Press the pawl of engine room harness (1) and pull up engine room harness in the direction of the arrow.

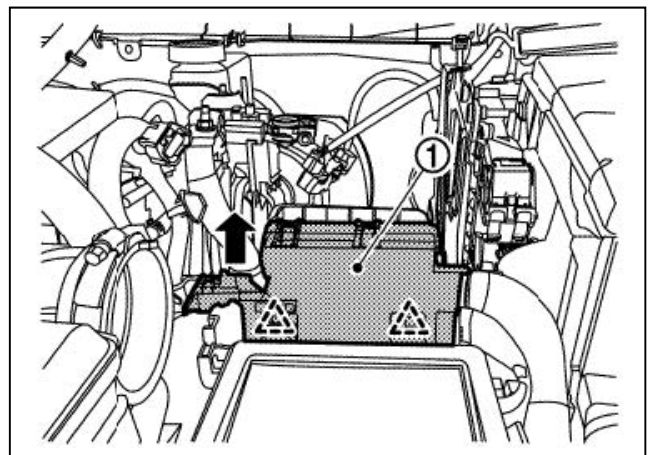

Figure 4

29. Disconnect the harness connectors from the ECM.

30. Remove the battery mounting bracket, battery tray 1 and battery tray 2.
  - Refer to the ESM: **ELECTRICAL & POWER CONTROL > POWER SUPPLY, GROUND & CIRCUIT ELEMENTS > REMOVAL AND INSTALLATION > BATTERY TRAY > Removal and Installation**
  
31. Remove the engine under cover.
  - Refer to the ESM: **BODY EXTERIOR, DOORS, ROOF & VEHICLE SECURITY > EXTERIOR > REMOVAL AND INSTALLATION > ENGINE UNDER COVER > Removal and Installation**
  
32. Remove the LH side wheel and tire assembly.
  
33. Remove the LH side splash guard.
  
34. Remove the LH side engine mounting insulator's body side lower bolts from underneath the vehicle.
  
35. Support the engine and transaxle assembly using a suitable jack.

**NOTICE**

To avoid damage to the vehicle, place the jack in an area to not damage the lower engine oil pan or transaxle oil pan.
  
36. Remove the LH side engine mounting insulator transaxle side bolts.
  
37. Lower the engine and transaxle assembly.
  
38. Remove the LH side engine mounting insulator body side bolts, and then remove the LH side engine mounting insulator.

## PR25DD Installation

39. Install and tighten the LH side engine mounting insulator bolts in the sequence shown in Figure 5 and Figure 6.

**HINT:** The arrow designates the front of the vehicle.

- Engine insulator bolt torque: 62 N•m (6.3 kg-m, **46 ft-lb**)

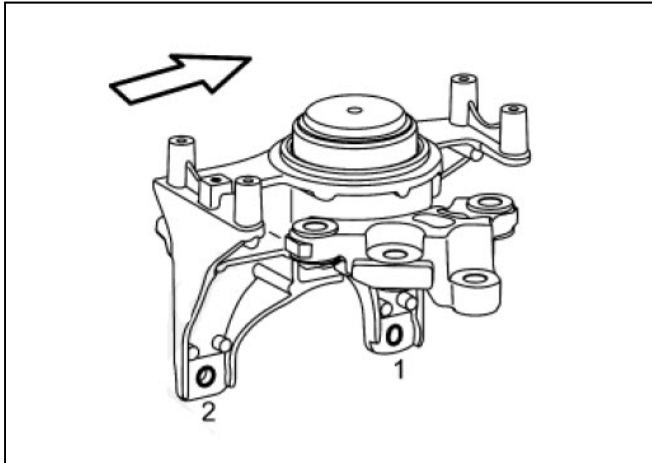

Figure 5

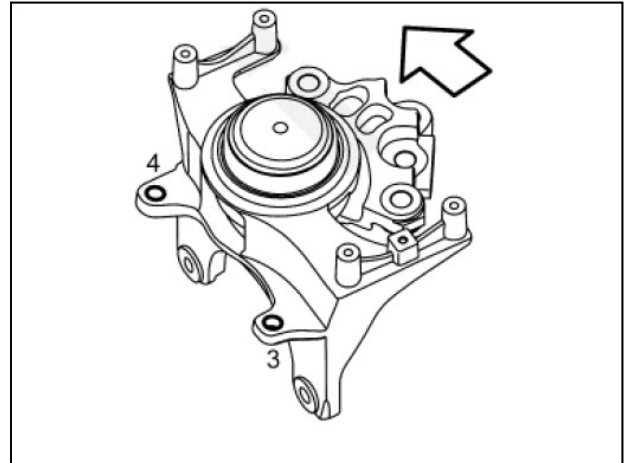

Figure 6

40. Install and tighten the transaxle side bolts (A).

**HINT:** The arrow designates the front of the vehicle.

- Engine insulator bolt torque:  
62 N•m (6.3 kg-m, **46 ft-lb**)

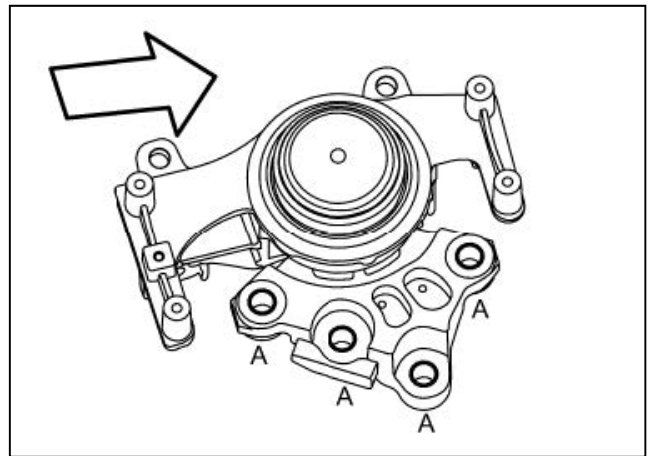

Figure 7

41. Reinstall all components in the reverse order of removal.
42. Perform **ADDITIONAL SERVICE WHEN REMOVING BATTERY NEGATIVE TERMINAL.**
- **ELECTRICAL & POWER CONTROL > POWER SUPPLY, GROUND & CIRCUIT ELEMENTS > BASIC INSPECTION > INSPECTION AND ADJUSTMENT > ADDITIONAL SERVICE WHEN REMOVING BATTERY NEGATIVE TERMINAL**

## CLAIMS INFORMATION

Submit a Primary Part (PP) type line claim using the following claims coding:

DESCRIPTION	PFP	OP CODE	SYM	DIA	FRT
RPL LH Insulator Mount	(1)	AW57AA	(2)	(2)	(3)

- (1) Reference the electronic parts catalog and use the LH Engine Mount Insulator (11220-\*\*\*\*\*) as the Primary Failed Part (**PFP**).
- (2) Reference the current Nissan Warranty Flat Rate Manual and use the appropriate symptom and diagnosis code for repair.
- (3) Reference the current Nissan Warranty Flat Rate Manual and use the indicated Flat Rate Time (**FRT**).

**HINT:** The new procedure in the bulletin will alter the Flat Rate Time (FRT) for operations involving removal of the LH Insulator mount from the vehicle. Refer to the current Nissan Warranty Flat Rate Manual for the current FRTs.

## AMENDMENT HISTORY

PUBLISHED DATE	REFERENCE	DESCRIPTION
February 23, 2024	NTB24-014	Original bulletin published

