



Technical Service Bulletin

SUBJECT:		No: TSB-24-42-002	
EV CHARGER LID REMOVAL AND INSTALLATION PROCEDURE CORRECTIONS/ADDITIONS – SERVICE MANUAL REVISION		DATE: April 2024	
		MODEL: Outlander Plug-in Hybrid	
CIRCULATE TO:	<input type="checkbox"/> GENERAL MANAGER	<input checked="" type="checkbox"/> PARTS MANAGER	<input checked="" type="checkbox"/> TECHNICIAN
<input checked="" type="checkbox"/> SERVICE ADVISOR	<input checked="" type="checkbox"/> SERVICE MANAGER	<input checked="" type="checkbox"/> WARRANTY PROCESSOR	<input type="checkbox"/> SALES MANAGER

PURPOSE

This TSB provides EV Charger Lid removal and installation procedure corrections and additional information in the applicable Service Manual.

AFFECTED VEHICLES

2023-2024 Outlander Plug-in Hybrid

AFFECTED SERVICE MANUAL

2023-2024 Outlander Plug-in Hybrid Service Manual

PROCEDURE

Please use the chart below to replace the pages in the affected 2023-2024 Outlander Plug-in Hybrid Service Manual Body section.

Applicable Manual	Pub. No.	Applicable Title	Content
2023 OUTLANDER (PHEV) Service Manual	<MMNA> MSCD-027B-2023	BODY EXTERIOR, DOORS, ROOF & VEHICLE SECURITY └ DOOR & LOCK └ REMOVAL AND INSTALLATION	Attached sheet 3
2024 OUTLANDER (PHEV) Service Manual	<MMNA> MSCD-027B-2024	└ CHARGING LID └ REMOVAL AND INSTALLATION	



Copyright 2024, Mitsubishi Motors North America, Inc.

The information contained in this bulletin is subject to change. For the latest version of this document, go to the Mitsubishi Dealer Link, MEDIC, or the Mitsubishi Service Information website (www.mitsubishitechinfo.com).

REMOVAL AND INSTALLATION

CHARGING LID

REMOVAL AND INSTALLATION

Post-installation operation

- EV Charger Lid Inspection (Refer to On-vehicle Service, EV Charger Lid Check).

<Corrected>

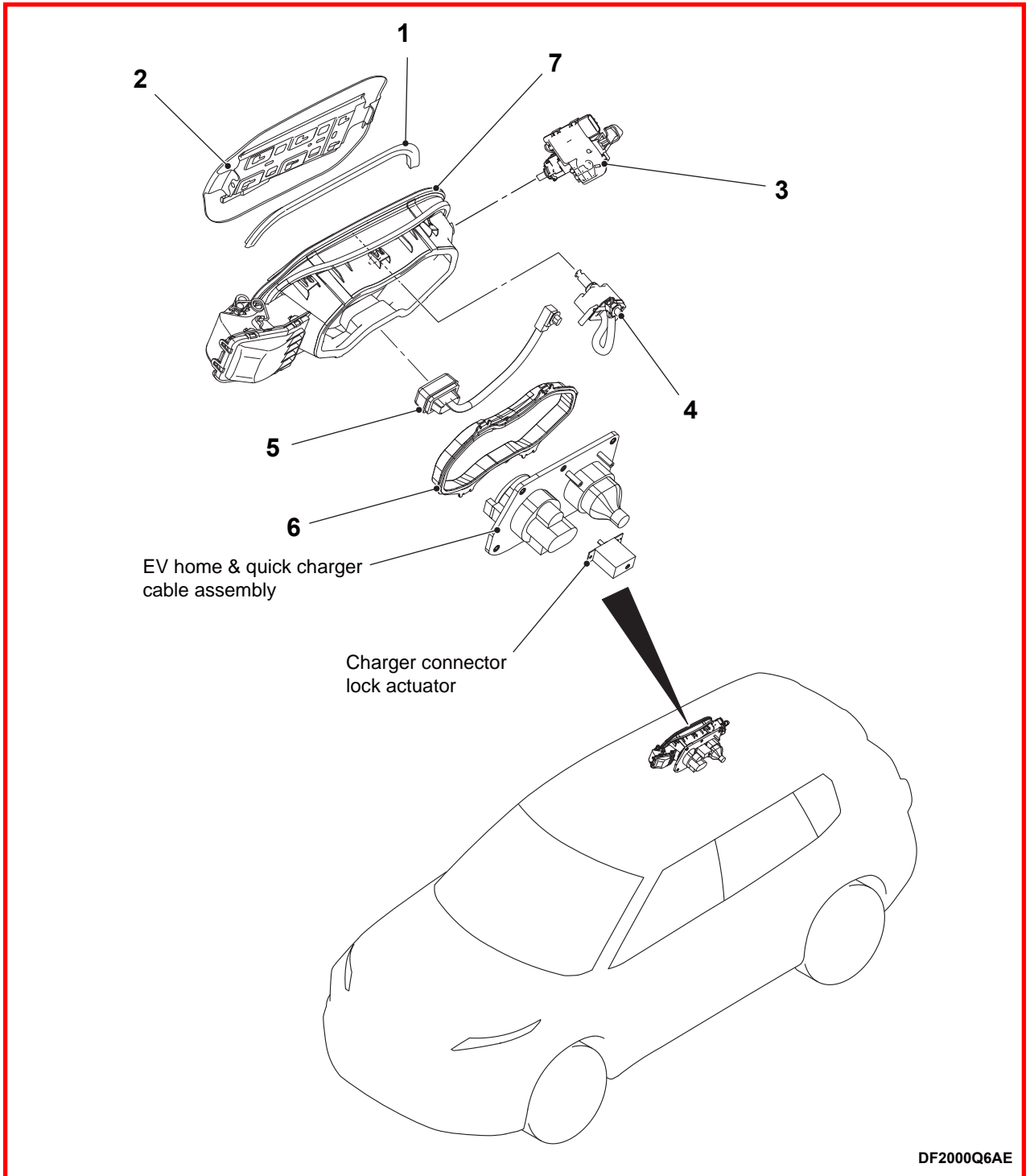

DF2000Q6AE

<Corrected>

		EV charger lid weatherstrip removal step	
>>B<<	1.	EV charger lid weatherstrip	
		EV charger lid assembly removal steps	
<<A>>	>>A<<	2.	EV charger lid panel
		<ul style="list-style-type: none"> • Luggage trim (RH) (Refer to Body Interior - Interior - Removal and Installation - Luggage Trim - Removal and Installation) • EV home & quick charger cable assembly (Refer to Electric Power Train - On Board Charger (OBC) / DC-DC Converter - EV Home & Quick Charger Cable - Removal and Installation) • Charger connector lock actuator (Refer to Electric Power Train - On Board Charger (OBC) /DC-DC Converter - EV Home & Quick Charger Cable - Removal and Installation) 	
		3.	EV charger lid lock sensor
		4.	EV charger lid lock release actuator
		5.	EV charger lid light
		6.	EV charger lid bracket
<>	7.	EV charger lid assembly	

REMOVAL SERVICE POINT

<<A>> EV CHARGER LID PANEL REMOVAL

1.Lift up the EV charger lid assembly claw.

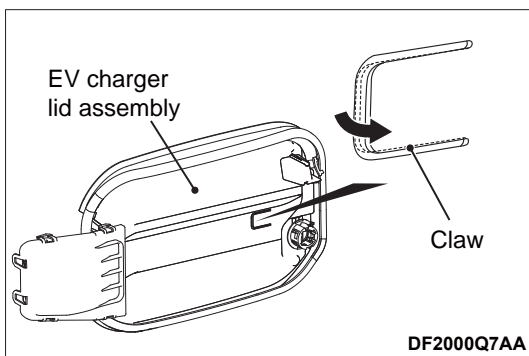

2.Slide the EV charger lid panel towards the rear of the vehicle and remove it.

<Added>

>>B<< EV CHARGER LID WEATHERSTRIP INSTALLATION

Align the edge of the EV charger lid weatherstrip with the reference plane and install it as shown in the figure.

