



	Date	Group	No.	Release	Page
SB-10051570-7636	2.2013	652	006	1	1(4)

Rear Suspension Adjustment Washers CHU, CXU, GU, TD

PI0812, Rear Suspension Adjustment Washers

(February 2013)

Replacement Procedure

You must read and understand the precautions and guidelines in Service Information, Group 6, "General Safety Practices, Wheel Suspension and Steering" before performing this procedure. If you are not properly trained and certified in this procedure, ask your supervisor for training before you perform it.

It has been determined that certain vehicles built with Maxlite suspensions and MGM LTR-L3 brake chambers interference can occur during suspension articulation between the brake chamber and the suspension adjustment washer. Replacement of the suspension adjustment washers is required.

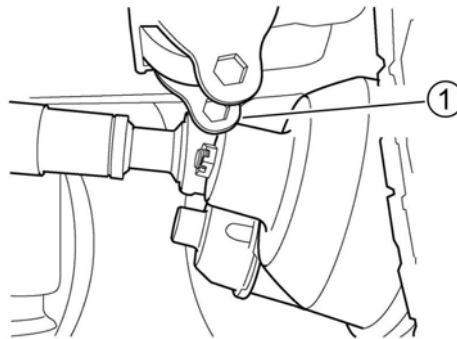

W6079024

1 Area of contact

Procedure

- 1 Chock the front tires and release the parking brake
- 2 Using a floor jack or hoist, lift the weight off of the spring and support with jack-stands underneath the frame.

Note: Place just ahead of the radius leaf spring/hanger requiring the eccentric washers on drivers side.

- 3 Remove the center bolt and replace the old washers with a pair of the new eccentric washers (21011478).

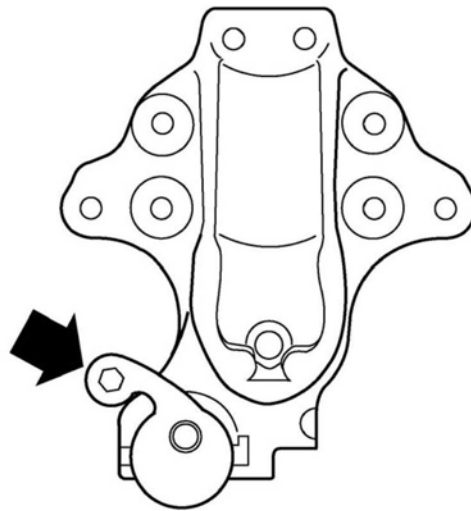

W6078694

- 4 Install the center bolt back into the radius leaf and hanger. Make certain the washers are installed correctly (see illustration). Loosely tighten center bolt at this time.
Note: Whenever the U-bolts are loosened and/or the suspension components attached to the axle are being worked on, make sure that the locating features on each component is properly engaged so that the components are positioned together properly.
- 5 Lower the weight of the frame down onto the spring assembly.
Note: Remove jack stand and jack.
- 6 Perform the above procedure on the other radius leaf spring assembly.

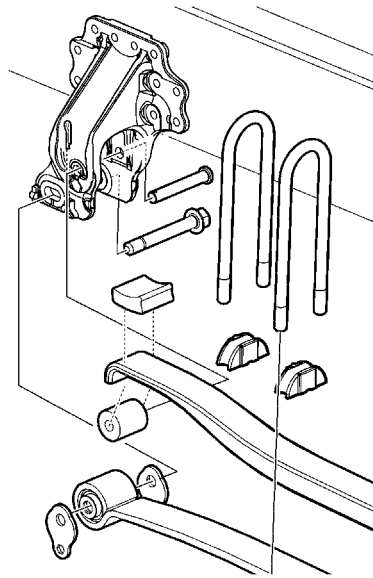

W7001358

7 Check and adjust tandem alignment as needed.

Note: Preliminary alignment only.

Note: It is recommended to have the vehicle machine aligned if available.

8 Torque both drivers side center bolts for the radius leaf springs to 678 – 712 Nm (500-525 lb-ft)

9 Set parking brake and remove chocks.

Reimbursement

This repair is covered by an authorized Service Program. Reimbursement is obtained via the normal claim handling process.	
Claim Type (used only when uploading from the Dealer Bus. Sys.)	B
Recall Status	
Vehicle inspected, repair not required	1- Inspected OK
Vehicle repaired per instruction	2- Modified per instruction
Labor Code	
Primary Labor Code	1352J-01-96 0.5 hrs
Time to take charge and determine campaign status	101AA-0A-00 — 0.3 hrs.
Causal Part	20551933
Parts Disposition	
Authorization Number	PI0812
Expiration Date	30 JUNE 2013