



Mack Trucks, Inc.  
Greensboro, NC USA

# Field Service Bulletin Trucks

Date 6.2013    Group **413**    No. **001**    Release **01**    Page 1(10)

SB-10052369-8712

Clutch Cable, Air Assist  
CHU, CXU, GU

## FSB 413-001, Clutch Cable, Air Assist

(June 2013)

Some Mack conventional cab trucks equipped with air assisted clutch cable part number 2108848 may experience fraying of the clutch cable at the clevis where it attaches to the clutch pedal linkage. A new clutch cable (part number 22175475) was designed to increase durability of the clutch cable and to prevent cable fraying at the clevis.

**Note:** This bulletin does not apply to MACK Trucks Australia.

### Required Parts

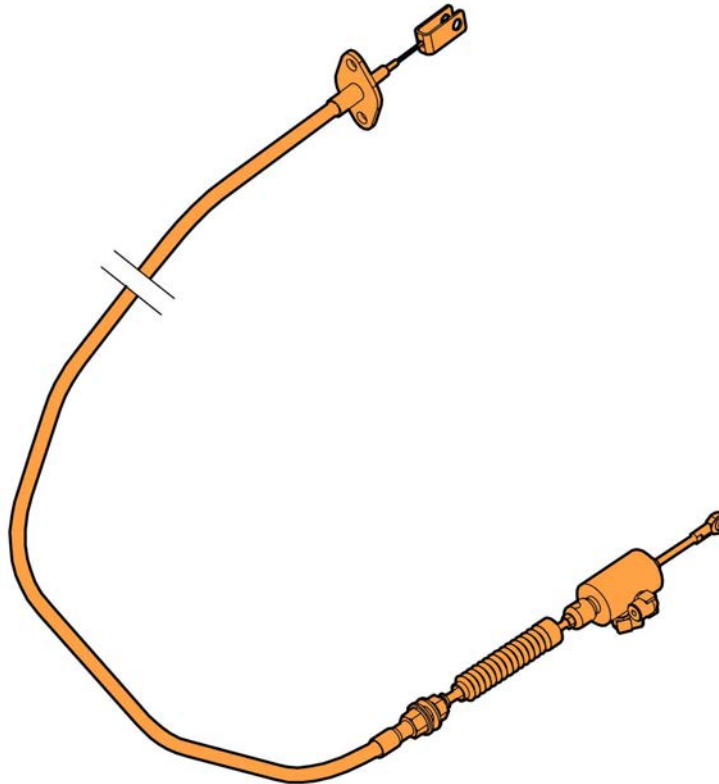

W4082280

Clutch Cable Control Assembly			
Item	Description	Part Number	Qty
1	Clutch Cable Control Assembly	22175475	1

**Note:** Information is subject to change without notice.

Illustrations are used for reference only and may differ slightly from the actual vehicle being serviced. However, key components addressed in this information are represented as accurately as possible.

## Procedure

You must read and understand the precautions and guidelines in Service Information, function group 40, "General Safety Practices, Transmission" before performing this procedure. If you are not properly trained and certified in this procedure, ask your supervisor for training before you perform it.



### DANGER

Do not attempt to repair or service this vehicle without having sufficient training, the correct service literature and the proper tools. Failure to follow this could make the vehicle unsafe and lead to serious personal injury or death.

- 1 Secure the vehicle for service by parking it on a flat level surface, applying the parking brake, chocking the rear wheels, and placing the transmission in neutral or park.
- 2 Disconnect all battery cables from the negative (ground) battery terminals to prevent personal injury from electrical shock and prevent damage to electrical components.
- 3 Unlatch and raise hood.
- 4 Remove the steering column cover and lower dash panel to access clutch cable clevis.

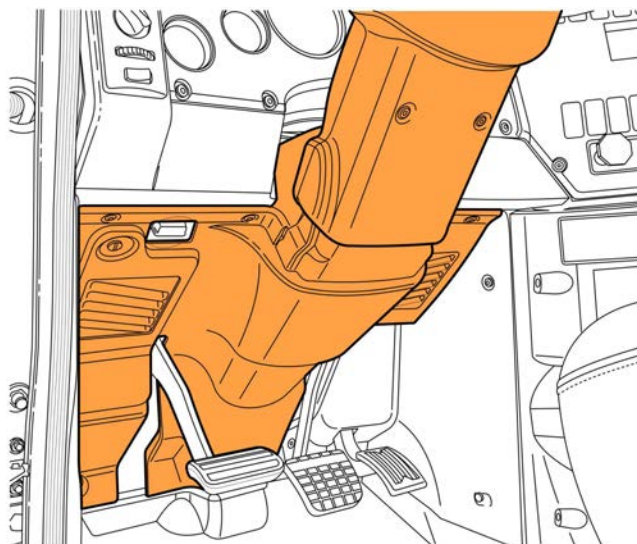

W4082281

- 5 Remove the clevis pin from clutch cable at pedal.

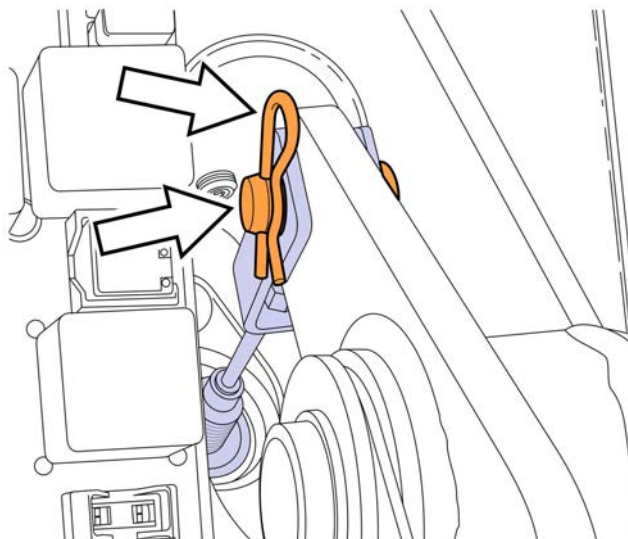

W4082282

- 6 Remove the fasteners securing the cable housing to bulkhead.

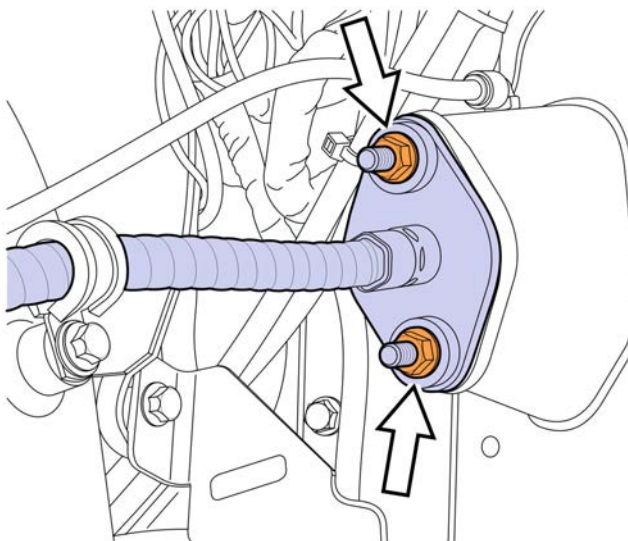

W4082283

7 Remove cable ties and clamps as needed.

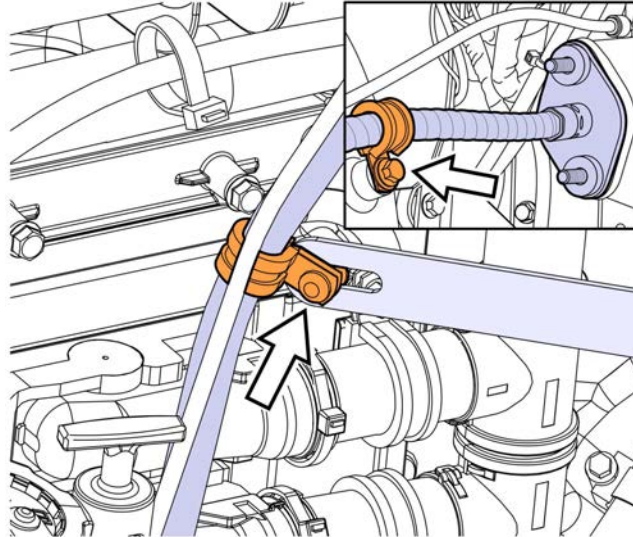

W4082284

8 Using air line release tool J-44773, disconnect the air lines to the clutch actuator.

**Note:** Note the orientation of the air lines to the clutch actuator.

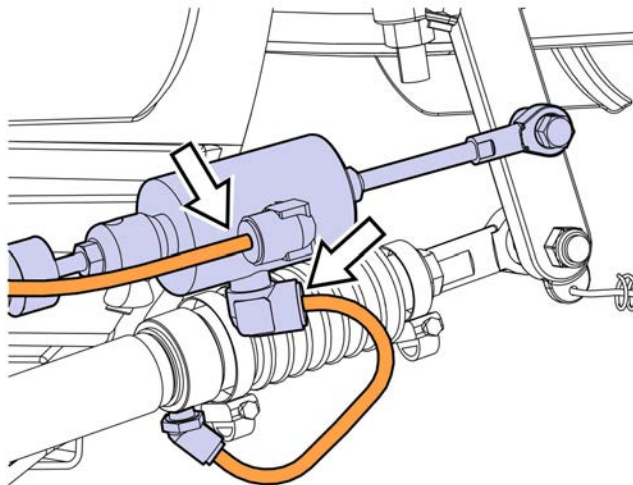

W4082285

9 Remove the fastener securing the clutch actuator to the clutch lever.

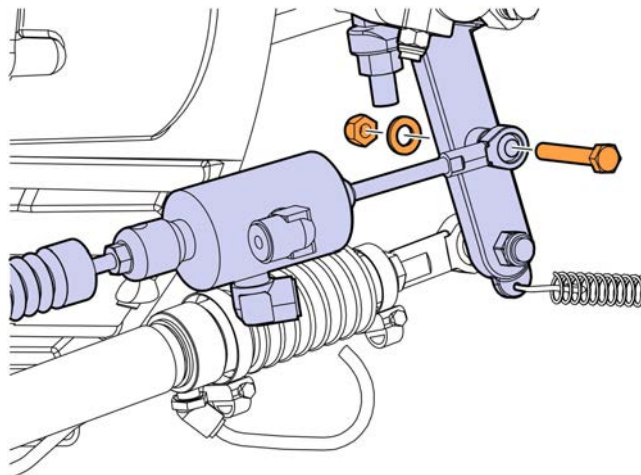

W4082286

10 Remove the cable from the engine mounted bracket.

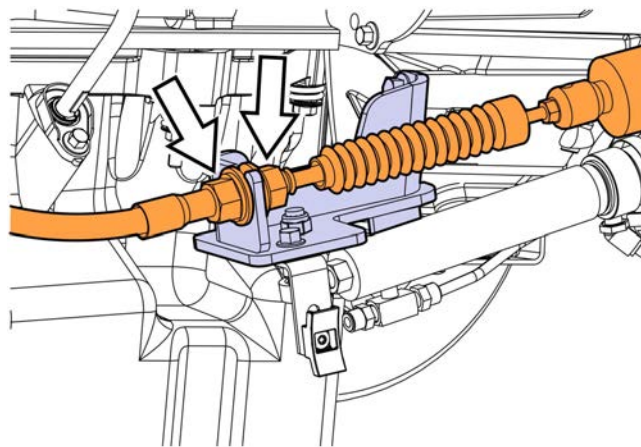

W4082287

- 11 Remove the existing clutch cable and actuator.
- 12 Position the replacement clutch cable and actuator.
- 13 Loosely install the replacement clutch cable into engine mounted bracket.

**Note:** Do not tighten nuts securing the replacement clutch cable to engine mounted bracket at this time.

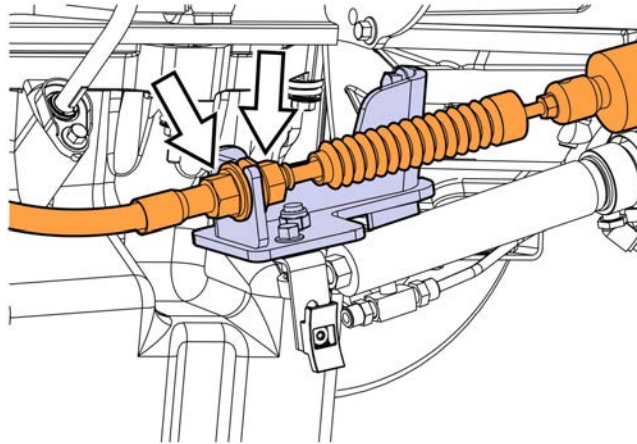

W4082287

- 14 Install the fastener (with spacer) securing the clutch actuator to the clutch lever.
- 15 Tighten fastener to  $24 \pm 4$  Nm ( $18 \pm 3$  ft-lb).

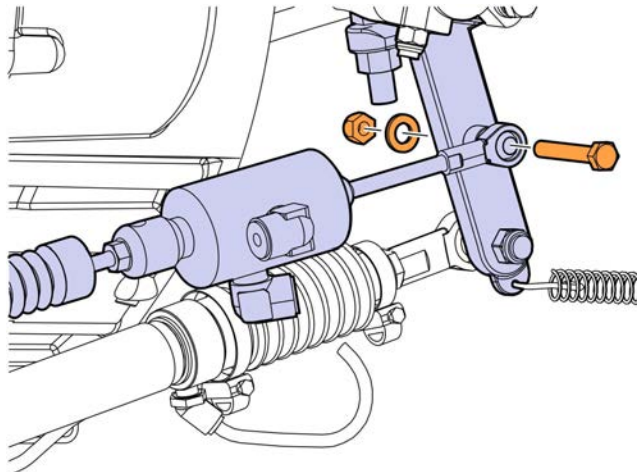

W4082286

16 Connect the air lines to the clutch actuator.

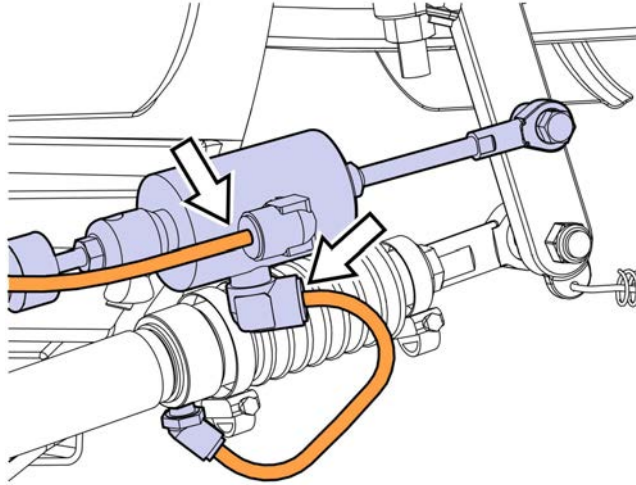

W4082285

17 Install the clutch cable housing to the bulkhead.

18 Tighten fasteners to  $24 \pm 4$  Nm ( $18 \pm 3$  ft-lb).

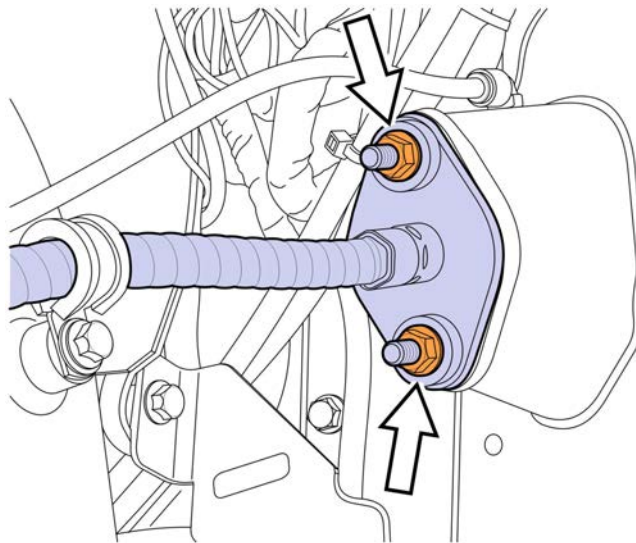

W4082283

19 Tighten nuts securing the clutch cable to the engine mounted bracket.

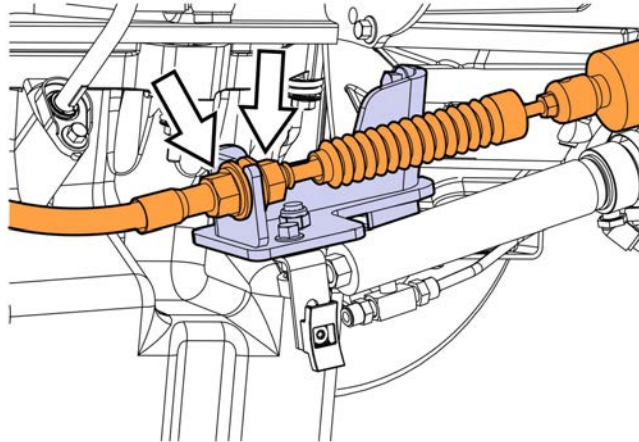

W4082287

20 Install cable ties and clamps securing the clutch cable.

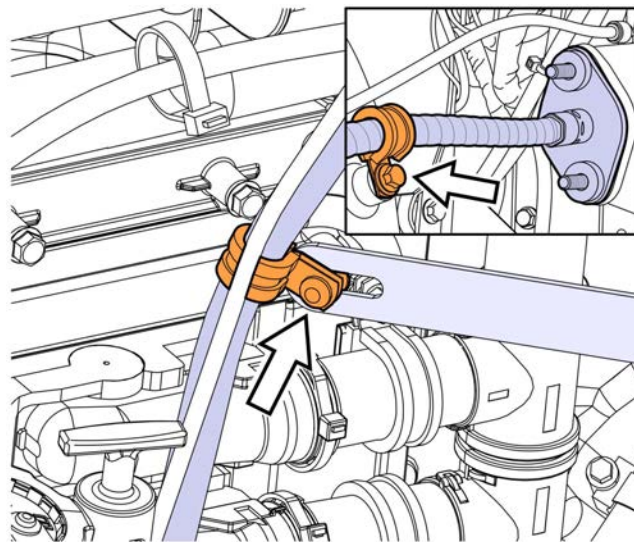

W4082284



21 Install the clevis pin into clutch cable at pedal.

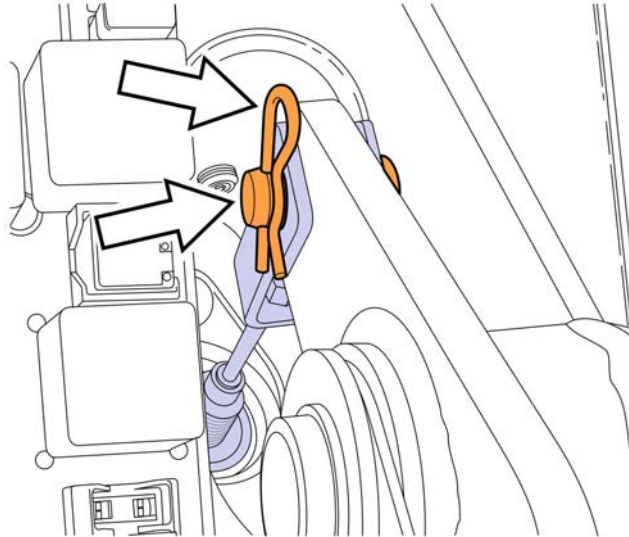

W4082282

22 Install the lower dash panel and steering column cover.

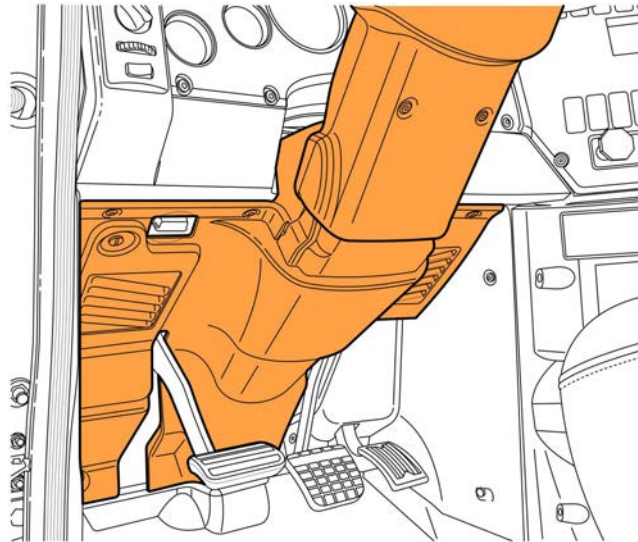

W4082281

23 Close and latch the hood.

24 Reconnect all previously removed cable to the negative (ground) battery terminals.

25 Start engine, check for proper operation of the clutch, and check for Air leaks.

**Note:** Adjust clutch If necessary (This is a separate operation).

26 Remove wheel chocks.

**Reimbursement**

<b>This repair may be eligible for reimbursement if a product failure was experienced within time and mileage limits of the applicable Warranty coverage. Reimbursement is obtained via the normal claim handling process.</b>	
<b>Claim Type (used only when uploading from the Dealer Bus. Sys.)</b>	01
<b>Labor Code</b>	
Primary Labor Code	3134A-01-80 0.6 hrs.
<b>Causal Part</b>	21088848

MACK Trucks North America engages in a continuous program of testing and evaluating to provide the best possible product. MACK Trucks North America, however, is not committed to, or liable for updating existing chassis.