



Service Bulletin

File in Section: -

Bulletin No.: PI0998

Date: June, 2013

PRELIMINARY INFORMATION

Subject: Accessory Tri-Fold Tonneau Cover Prevents Endgate/Tailgate from Closing

Models: 2014 Chevrolet Silverado Light Duty
2014 GMC Sierra Light Duty

Condition/Concern

Some customers may comment that the tailgate will not close with the tri-fold tonneau cover in the closed position. This may be due to an early production condition caused by excessive twist in the rear rail of the tonneau cover, and the tailgate molding is not positioned flat on top of the tailgate.

Recommendation/Instructions

Improve the clearance from the rear rail to tailgate by conducting the following steps below.

Note: DO NOT replace the tonneau cover for this condition.

1. Open the tonneau cover.

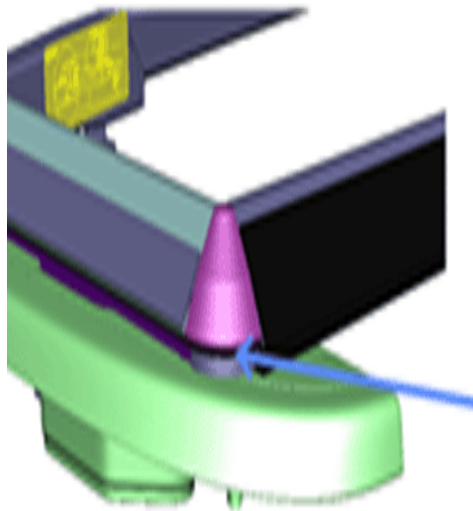

3461386

2. Remove the adhesive liner from the pad and attach to the rear current corner pads on the right and left side as shown in the illustration above.

Note: If additional clearance is required, add a second layer of corner pads to each side.

3. Close the cover and inspect fit and tailgate operation.

Note: The corner pads will take a compression set over time and should resolve any gaps present between the side seal and the pickup box top present immediately after installation.

Parts Information

Part Number	Description	Qty.
22900409	Pad	As Needed

Warranty Information

For vehicles repaired under warranty, use:

Labor Operation	Description	Labor Time
0580018*	Adding Adhesive Pad To The Right And Left Rear Corner Pads	0.2 hr
*This is a unique labor operation for bulletin use only. It will not be published in the Labor Time Guide.		