



Service Bulletin

File in Section: -

Bulletin No.: P11037

Date: August, 2013

PRELIMINARY INFORMATION

Subject: Oil Pressure Switch Replacement Information

Models: 2013 Buick Encore
2011-2013 Chevrolet Cruze, Volt
2012-2013 Chevrolet Sonic
Equipped with Engine RPOs LUW, LWE, LUJ, LUU, LUV

Condition/Concern

If replacement or removal of the oil pressure switch is necessary, it is important to torque the switch to the right specification. There is the possibility to have one of two switches available for replacement. Each switch has a different torque specification depending on which engine they are used on. Please see pictures below for reference.

LUW and LWE Oil Pressure Switch – 40 N•m (30 lb ft)

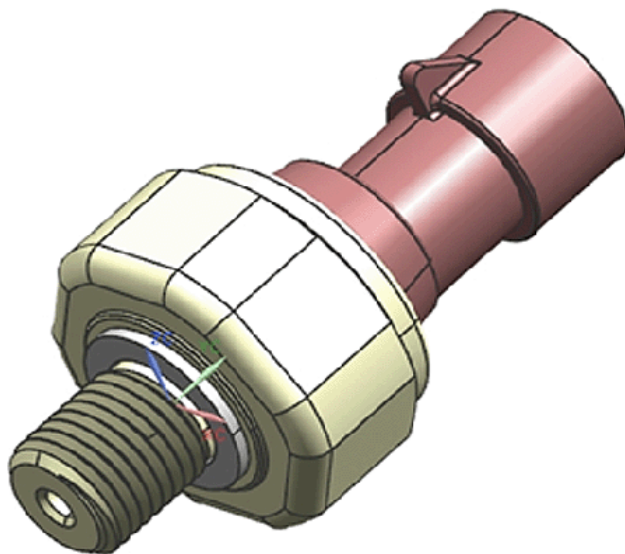

LUW, LWE, LUJ, LUV & LUU Oil Pressure Switch – 20 N•m (15 lb ft)

