



**IMPORTANT SERVICE
INFORMATION FOR:**

- ✓ SERVICE MANAGER
- ✓ SERVICE ADVISOR
- ✓ WARRANTY PERSONNEL
- ✓ TECHNICIAN
- ✓ PARTS DEPARTMENT

BULLETIN NUMBER:
SB16-C-001

ISSUE DATE:
JULY 2016

GROUP:
GLASS AND INTERIOR

DOOR WIND NOISE/WATER INTRUSION – IMPROVED DOOR SEAL AND ADJUSTMENT PROCEDURE

AFFECTED VEHICLES

- 2011-2017 MY Isuzu N-Series Trucks, Single Cab

INFORMATION

CONDITION

Some customers may complain about wind noise and/or water intrusion into the cab from the driver and/or passenger doors of the Single Cab N-Series Truck.

To correct this condition Isuzu is offering a new door weather strip to improve sealing of the driver and passenger doors for single cab trucks.

SERVICE PROCEDURE

WEATHER STRIP REMOVAL & INSTALLATION

1. Remove the passenger door sill protector by removing four (4) screws. (See Figure 1)
2. Remove the old weather strip by pulling weather strip away from the cabin pinch weld surface. (See Figure 2)

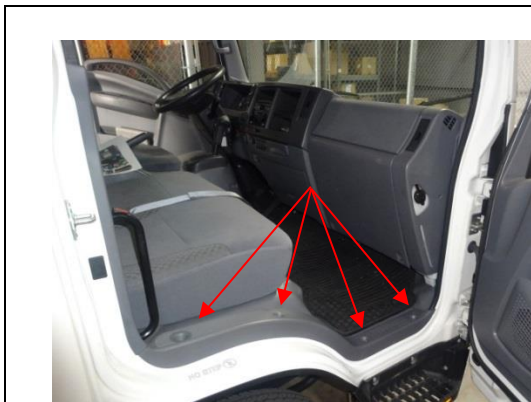

Figure 1

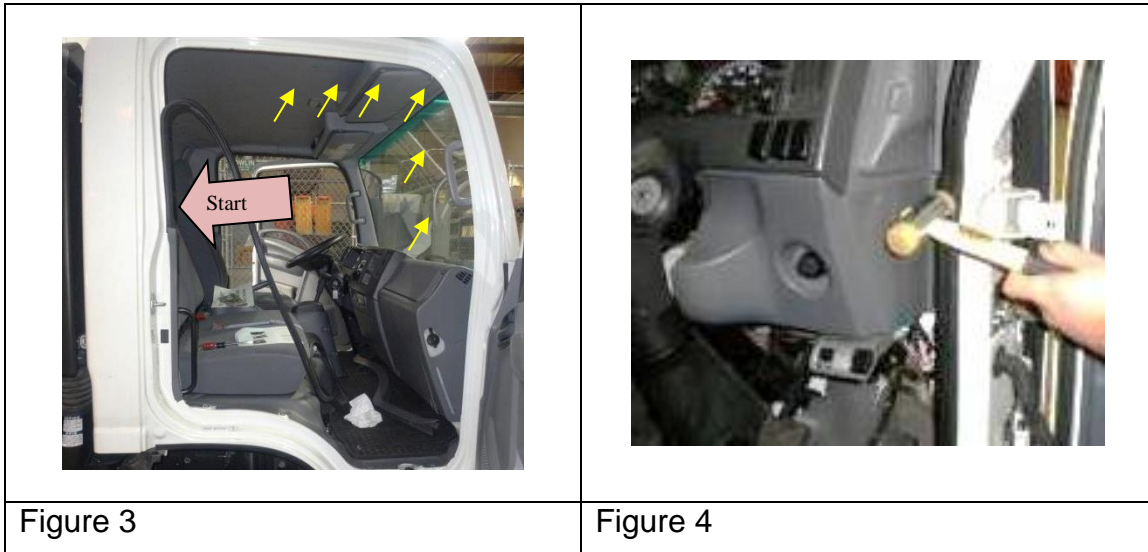

Figure 2

3. Wipe down the pinch weld surface using a clean cloth. (Yellow arrows, Figure 3)

CAUTION: BE CAREFUL OF SHARP EDGES.

4. Attach the new weather strip to the pinch welding surface, starting at the rear quarter side, marked by the red arrow in Figure 3, and work towards the front.
5. Using a rubber mallet, ensure the weather strip is fully seated. (See Figure 4)



6. Install the door sill protector. (Refer back to Figure 1)
 - a. If the new seal interferes and sits below the door side sill protector, as shown in Figure 5 below, proceed to Step 7.
 - b. If there is no interference repeat on other side.
 - c. If both doors have been completed, skip to Step 14 to check door alignment.

NOTE: Weather strip should fit into the door sill protector without interference (See Figure 8)

IF WEATHER STRIP INTERFERES WITH DOOR SILL PROTECTOR

7. Using a pen, mark the seal using the top of the door side sill protector as a guide to where the weather strip needs to be cut. (See Figure 5)

NOTE: Weather strip is removed from vehicle for photo purposes. Procedure can be done with weather strip on the vehicle. (See Figure 6)

8. Remove sill plate and remove lower part of weather strip to be cut from cab
9. Using sharp scissors cut both sides of the weather strip at the attachment points up to where the pen mark is in Figure 6.

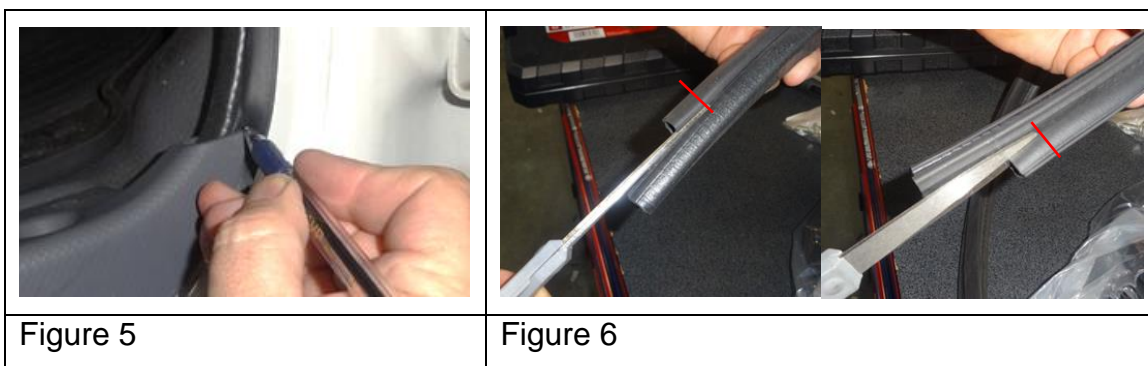

10. Cut off the piece of the seal that is interfering with the door sill protector. (See Figure 7)

NOTE: Weather strip should fit into the door sill protector without interference.

(See Figure 8)

11. Reinstall weatherstrip onto cab pinch weld using mallet to seat. (See Figure 4)

12. Reinstall door sill protector.

13. Repeat procedure for other side of vehicle.

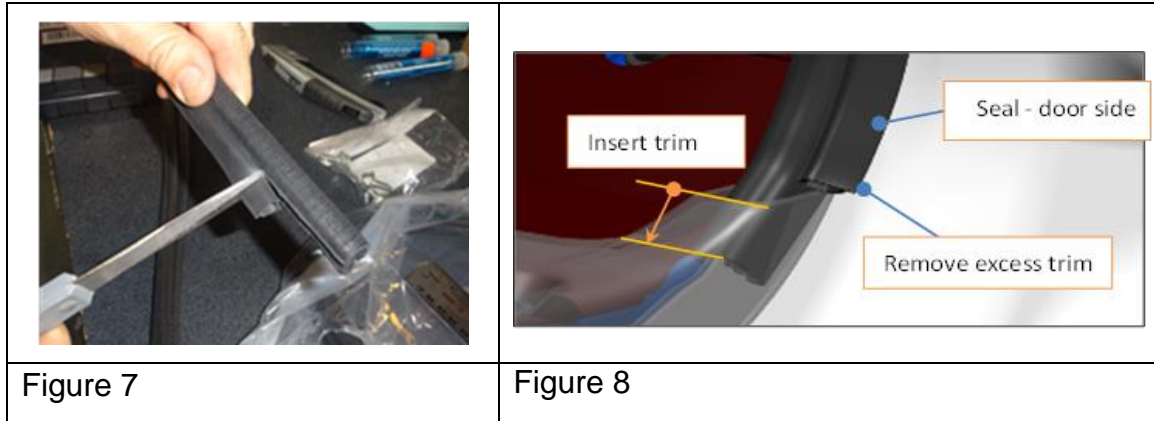

DOOR ALIGNMENT INSPECTION

14. Using two metric rulers as shown in Figures 9, 10, and 11, measure gaps of both doors at the locations shown in Figure 12. Specifications are shown in Table 1.

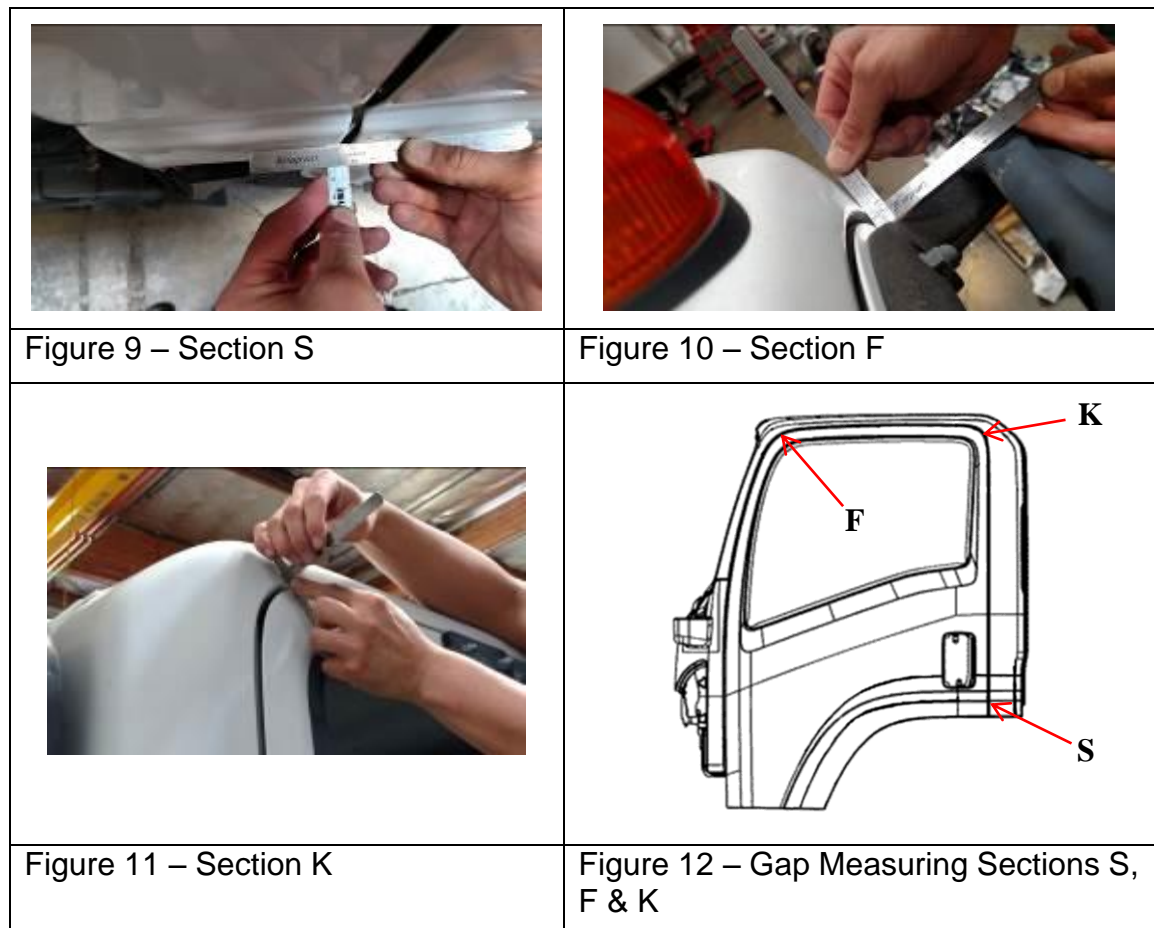
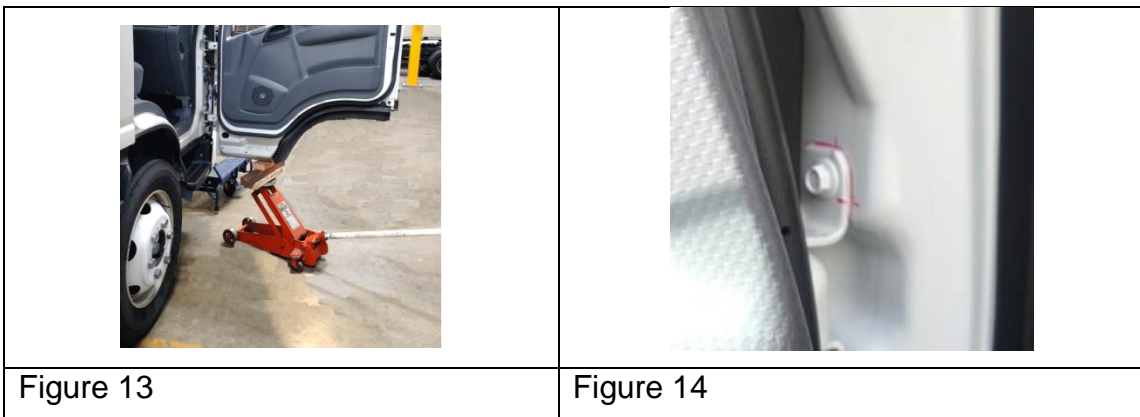

TABLE 1		
Door Gap Specifications		
Location	Measurement	
F & K	5.1mm	+/- 1.5mm
S	5.2mm	+/- 1.5mm

15. Close the door to ensure there is no binding and that the door closes correctly.
 - a. If the doors are in alignment and not binding, no further action is necessary.
 - b. If doors are not aligned or bind and adjustment is necessary, proceed to Door Adjustment, Step 16.

DOOR ADJUSTMENT

16. Open and support the door with a piece of wood using a floor jack. (See Figure 13)
17. Using a grease pencil make an alignment mark for reference on the door hinge and front door panel. (See Figure 14)



18. Loosen the bolt Number 1 using a 3/8" drive ratchet, a 1" long-3/8" drive extension, and a 12mm crow's foot. After the bolt is loose, remove the bolt using a 12mm wrench. (See Figure 15) Replace bolt Number 1 with a new bolt, the part number for which is provided in this bulletin.

IMPORTANT: DO NOT TORQUE BOLTS UNTIL AFTER DOOR ALIGNMENT IS COMPLETED.

19. Install the new bolt by hand-tightening, and then secure the bolt with the same tools used to remove it earlier.

NOTE: The bolts should be loose enough that the door/hinge can be moved but still tight enough that the assembly does not move freely.

20. Repeat Steps 15 and 16 for bolts 2, 3, and 4.

NOTE: The gap between the top of the door and the cabin should be adjusted with the window down to prevent glass breakage.

21. Adjust the doors.

- a. If the door protrudes from the body or is recessed into the body lines, adjust the door where the door hinge bolts to the door marked by red arrows in Figure 16.
 - Red arrows – moving the door away from the interior will raise the door from the cab when the door is closed.
 - b. If the door is not centered in the door frame, adjust the door where the door hinge bolts to cab, marked by blue arrows in Figure 16.
 - Blue arrows – move the door in the direction needed to center the door in the door frame.
22. When the doors have been adjusted correctly, torque all the door bolts to the specified torque using a 3/8” drive torque wrench, a 1” long-3/8” drive extension, and a 12mm crow’s foot.

Tightening Torque: 21.6 Nm (15.9 ft. lb.)

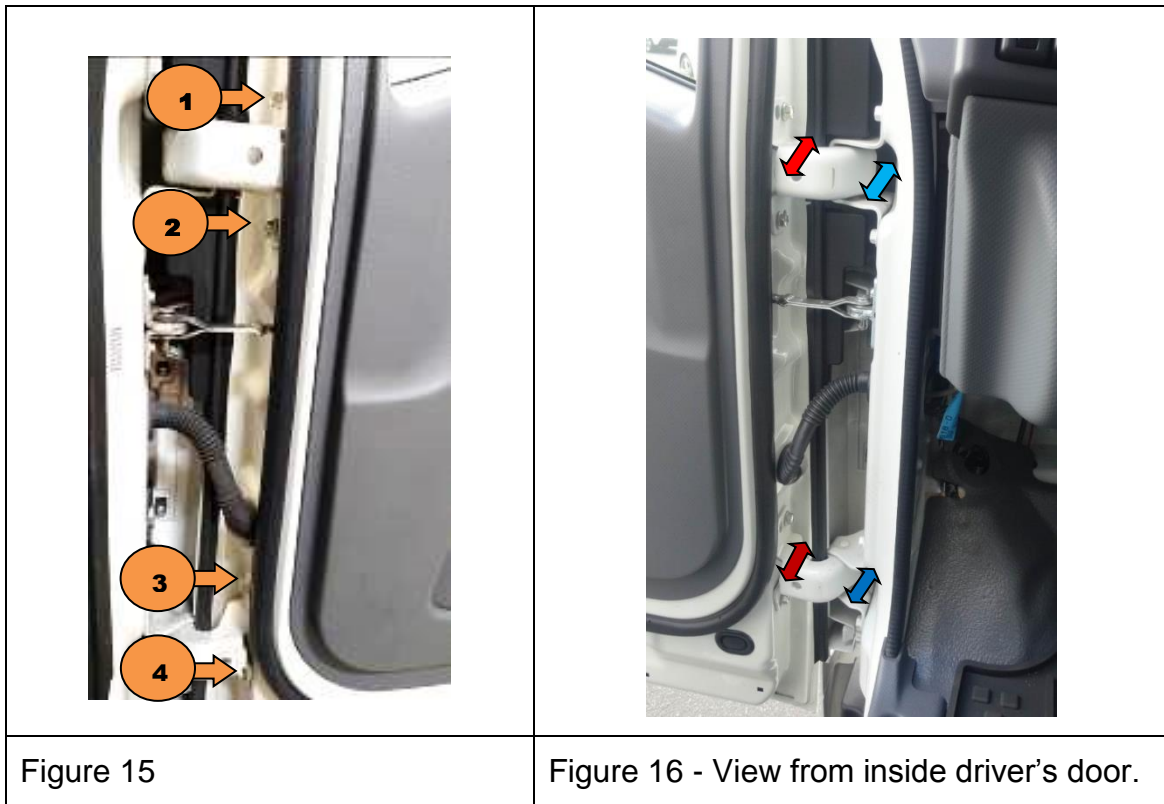

PARTS INFORMATION

The following parts information is provided to assist in any repairs. Parts are to be obtained from AIPDN.

Part Number	Description	Qty
8-98298-078-0	Weather Strip, Single Cab	2 (1 per side)
8-98049-756-0	Hinge Bolt	8 (4 per side), as needed

WARRANTY INFORMATION

The following labor operation information is provided for warranty claim submission and applicable to vehicles still under base warranty.

Labor Operation	Description	Labor Time
C1067	WEATHERSTRIP REPLACE – W/O DOOR ADJUST – BOTH DOORS	0.6
C1068	WEATHERSTRIP REPLACE – W/ DOOR ADJUST – BOTH DOORS	1.4