

TECHNICAL BULLETIN
LTB00896NAS1
19 FEB 2016



© Jaguar Land Rover North America, LLC

NOTE: The information in Technical Bulletins is intended for use by trained, professional Technicians with the knowledge, tools, and equipment required to do the job properly and safely. It informs these Technicians of conditions that may occur on some vehicles, or provides information that could assist in proper vehicle service. The procedures should not be performed by 'do-it-yourselfers'. If you are not a Retailer, do not assume that a condition described affects your vehicle. Contact an authorized Land Rover service facility to determine whether this bulletin applies to a specific vehicle.

SECTION: 501-03

Powered Tailgate Anti-Pinch Strip Modification

AFFECTED VEHICLE RANGE:

Discovery Sport (LC)

Model Year: 2015 Onwards
VIN: 500429 Onwards
Assembly Plant: Halewood

MARKETS:

NAS

CONDITION SUMMARY:

Situation: On vehicles fitted with a powered tailgate, water may enter the luggage compartment when the tailgate is opened.

Cause: This may be caused by water being trapped on the anti-pinch strip installation points when the tailgate is in the closed position.

Action: Should a customer express this concern, follow the Service Instruction below.

PARTS:

LR006101 Lantern Clip Quantity: 10

TOOLS:

Refer to Workshop Manual / Service Instruction for any required special tools.

WARRANTY:

 **NOTE: Repair procedures are under constant review, and therefore times are subject to change; those quoted here must be taken as guidance only. Always refer to TOPIx to obtain the latest repair time.**

 **NOTE: DDW requires the use of causal part numbers. Labor only claims must show the causal part number with a quantity of zero.**

DESCRIPTION	SRO	TIME (HOURS)	CONDITION CODE	CAUSAL PART
Anti-pinch strip modification - Pair	76.13.89.40	0.2	07	LR058521

 **NOTE: Normal Warranty procedures apply.**

COMPONENT LOCATION:

1.  **NOTE: right-hand shown; left-hand similar.**

Component location.

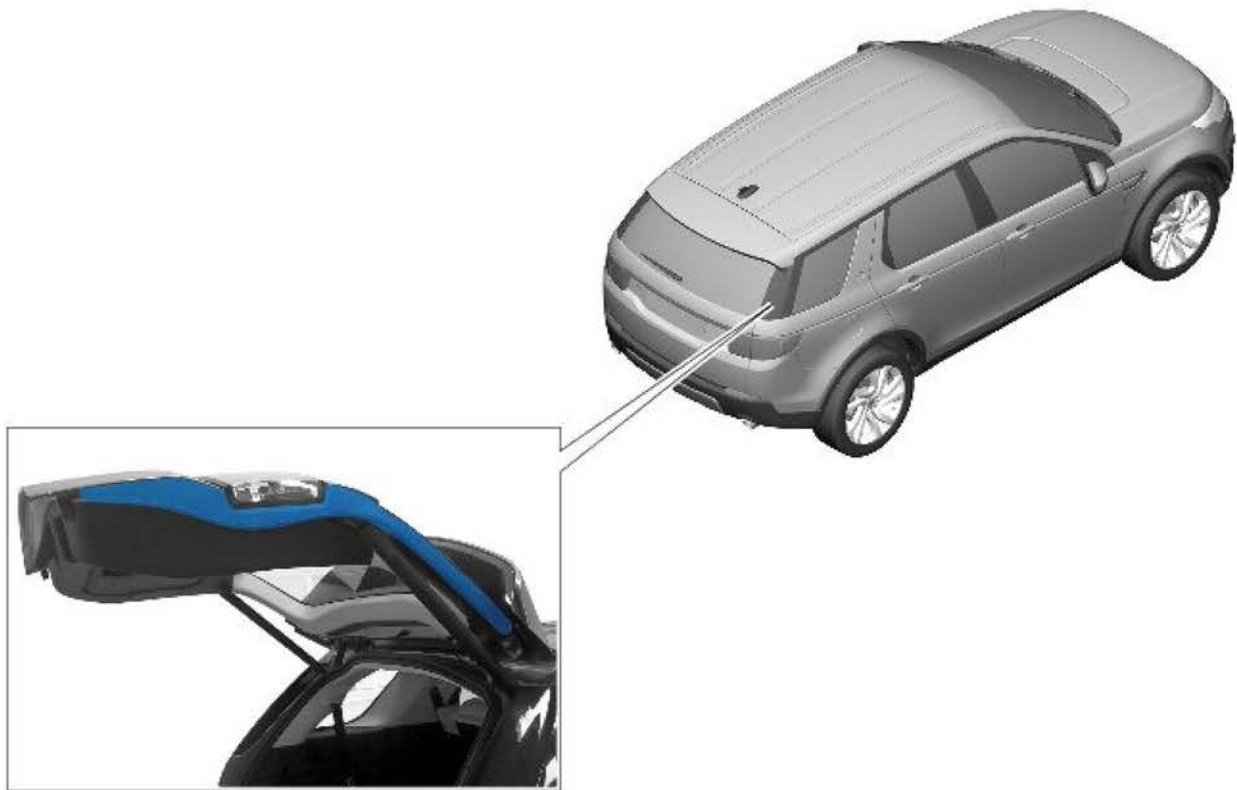

E187979

SERVICE INSTRUCTION:

1. Open the tailgate.

2.  **CAUTION: make sure no damage is caused to the tailgate paintwork.**

 **NOTE: repeat this step on both sides of the vehicle.**

 **NOTE: do not disconnect the electrical connector.**

 **NOTE: right-hand shown; left-hand similar.**

Remove the right-hand anti-pinch strip from the tailgate.

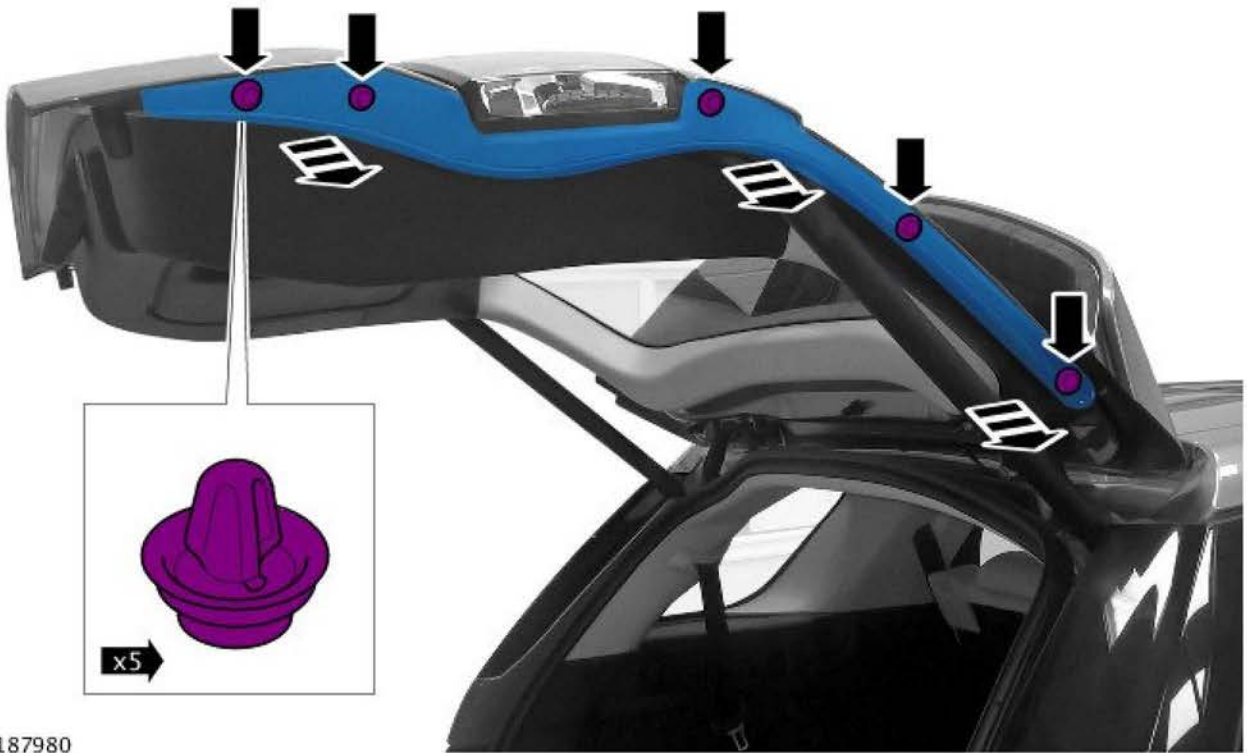

E187980

3.  **NOTE: repeat this step on both sides of the vehicle.**

Use a suitable tool to measure and mark the areas to be drilled.

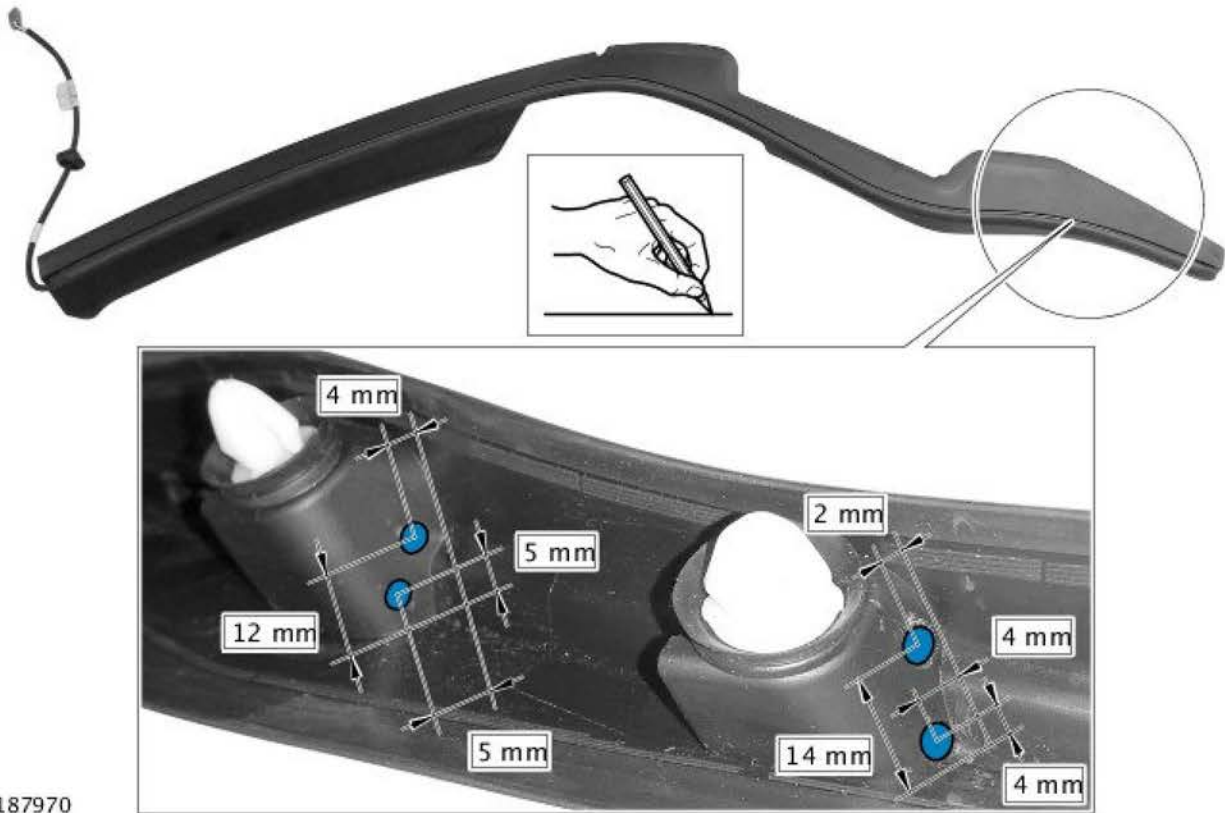

E187970

4.  **CAUTION: do not drill through to the visible side of the anti-pinch strip**

 **NOTE: repeat this step on both sides of the vehicle.**

Using a suitable tool, drill four 4 mm holes in the areas shown.

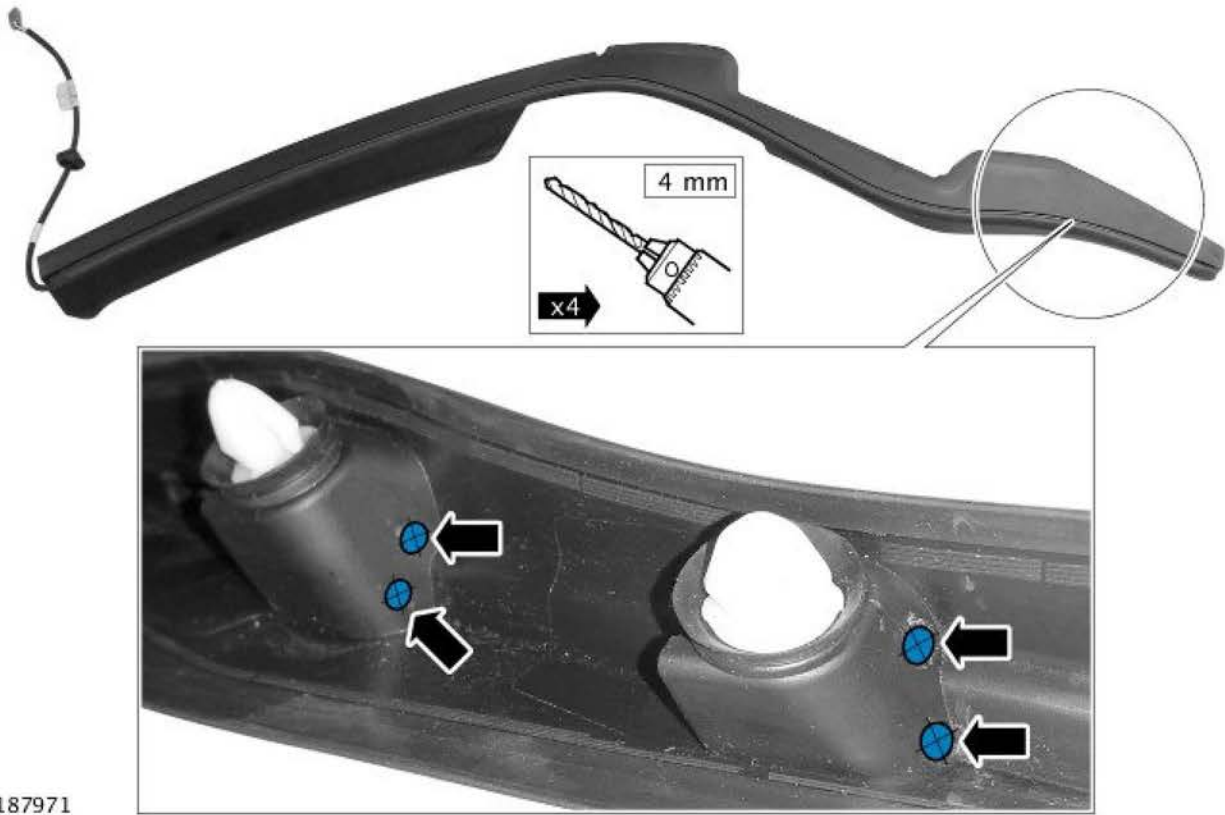

E187971

5.  **NOTE: repeat this step on both sides of the vehicle.**

Use a suitable tool to measure and mark the area to be drilled.

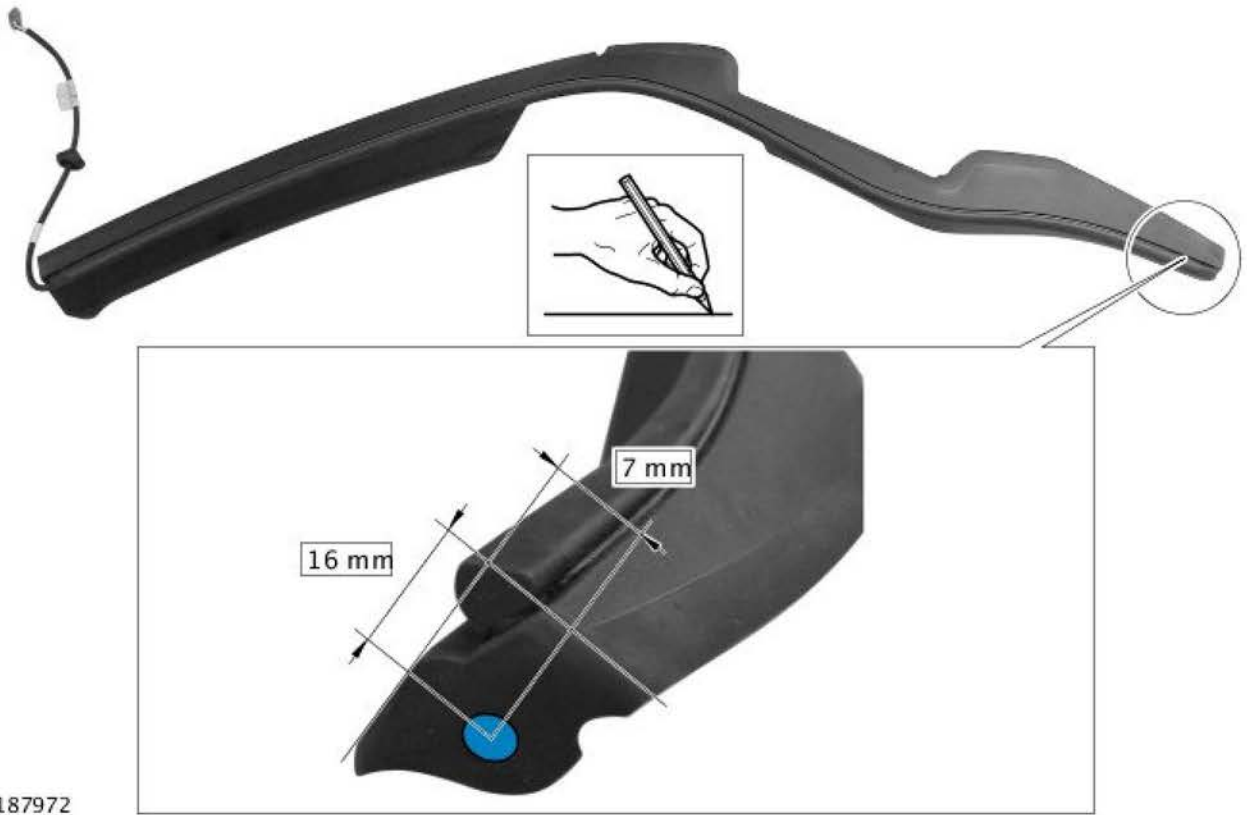

E187972

6.  **NOTE: repeat this step on both sides of the vehicle.**

Using a suitable tool, drill a 6 mm hole in the area shown.



E187973

7.  **CAUTION: make sure no damage is caused to the tailgate paintwork.**

 **NOTE: repeat this step on both sides of the vehicle.**

Install the right-hand anti-pinch strip to the tailgate.

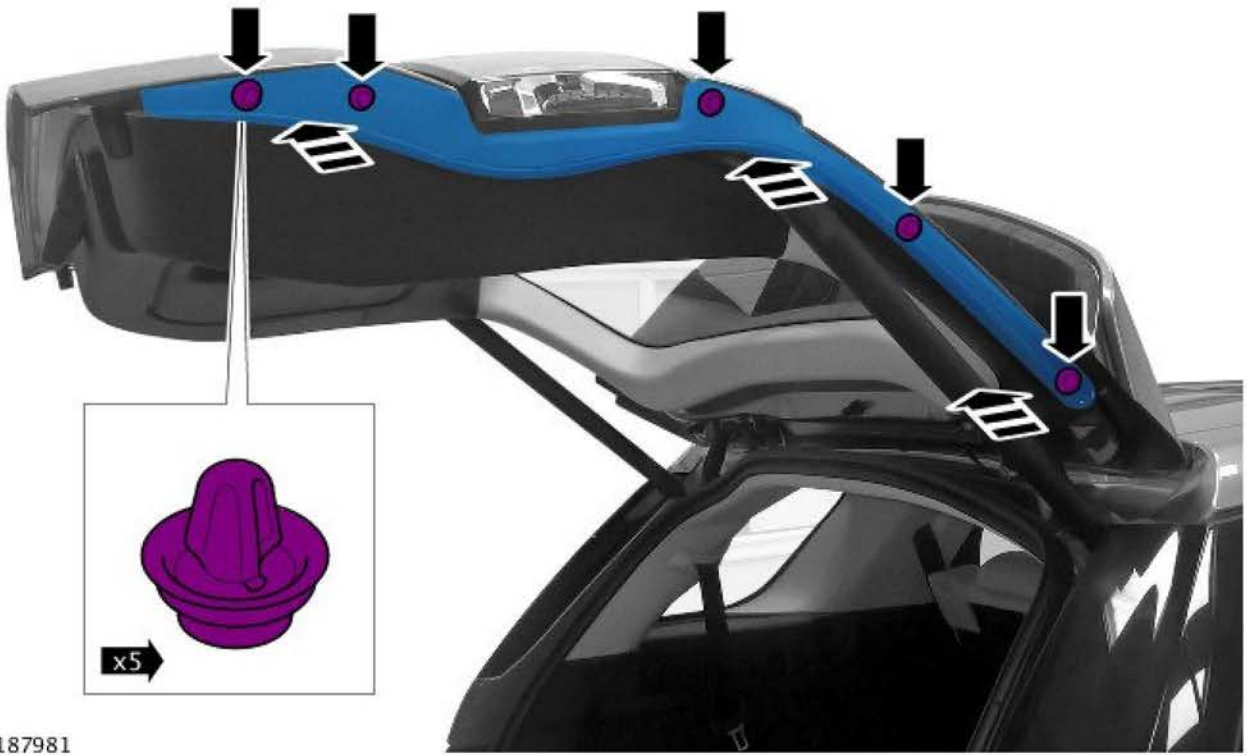

E187981

8. Close the tailgate.